

VAN<sup>®</sup>



# CONTENTS

Vaan Fundamentals	4
The Vaan Mission	18
The Vaan Range	26
R4	30
R5	52
R6	78
R8	104
Options	124



## GO ANYWHERE SAILING YACHTS

Vaan catamarans are designed to go anywhere. From the cold, high latitude Lofoten islands to the hot Caribbean. From the peaceful Bahama's to the fierce Baltic sea. The tough and rigid aluminium hull provides a quiet, unbreakable shell for your comfortable, luxury voyages. No matter the conditions outside.

# MADE FOR SAILORS

A Vaan is made for sailors. For the sensation of the water and the wind. It's meant to excite and explore. With twin aft helm stations, good upwind performance and a low boom, this cat is made for sailors.



A white Vaan catamaran sailboat is shown from a side-rear perspective on a body of water at sunset. The sky is a mix of orange, yellow, and blue. The boat's interior is illuminated with warm yellow lights, and its exterior has some glowing accents. The mast and rigging are visible against the sky.

## ARRIVE IN STYLE

With its minimalist styling and smart design solutions, a Vaan is both alluring and ergonomical. Easy to handle and robust. The warm, natural interior creates a light and balanced atmosphere. A perfect place to enjoy a good time, and arrive in style.

The image shows the interior of a yacht's saloon during the "blue hour" of dusk. The space is illuminated by warm, recessed ceiling lights. On the left, there is a U-shaped beige leather sofa with two textured throw pillows. In front of it is a square wooden table on a silver pedestal base, set with plates, glasses, and a small vase of flowers. A black metal chair with a woven seat is tucked under the table. To the right, a white kitchen unit features a built-in oven and a countertop with a coffee machine and other items. A person is blurred in motion in the center-right, moving from the kitchen area towards the seating area. Large wrap-around windows provide a panoramic view of the water and a distant shoreline. A thick black pillar stands in the middle of the room. The floor is made of light-colored teak planking.

## HOME AWAY FROM HOME

In the evening, when lights are dimming, the saloon provides a spectacular view of the surroundings. The wrap-around windows give a great sense of freedom and transparency, with all the coziness you want from a home.



## BEDROOM WITH A VIEW

The aft owners bedroom has a comfortable full size bed with beautiful views to the side, rear and top. Plenty of storage on the side of the bed and closet space for first essentials. A warm and private space where you can just drift away.



## THE WALK-IN CLOSETS

A Vaan is all about space, and no place makes that more clear than the walk-in closet in the owners hull.

The tall closet space on the right holds enough clothes to spend months away from home and buy some new ones along the way. The optional dresser on the left offers you extra drawers for your accessories.

## A TRUE BATHROOM

The forward cabin in the owners hull holds a superior bathroom with a spacious shower. The mirror slides sideways and three large drawers and shelves give you all the storage you need.



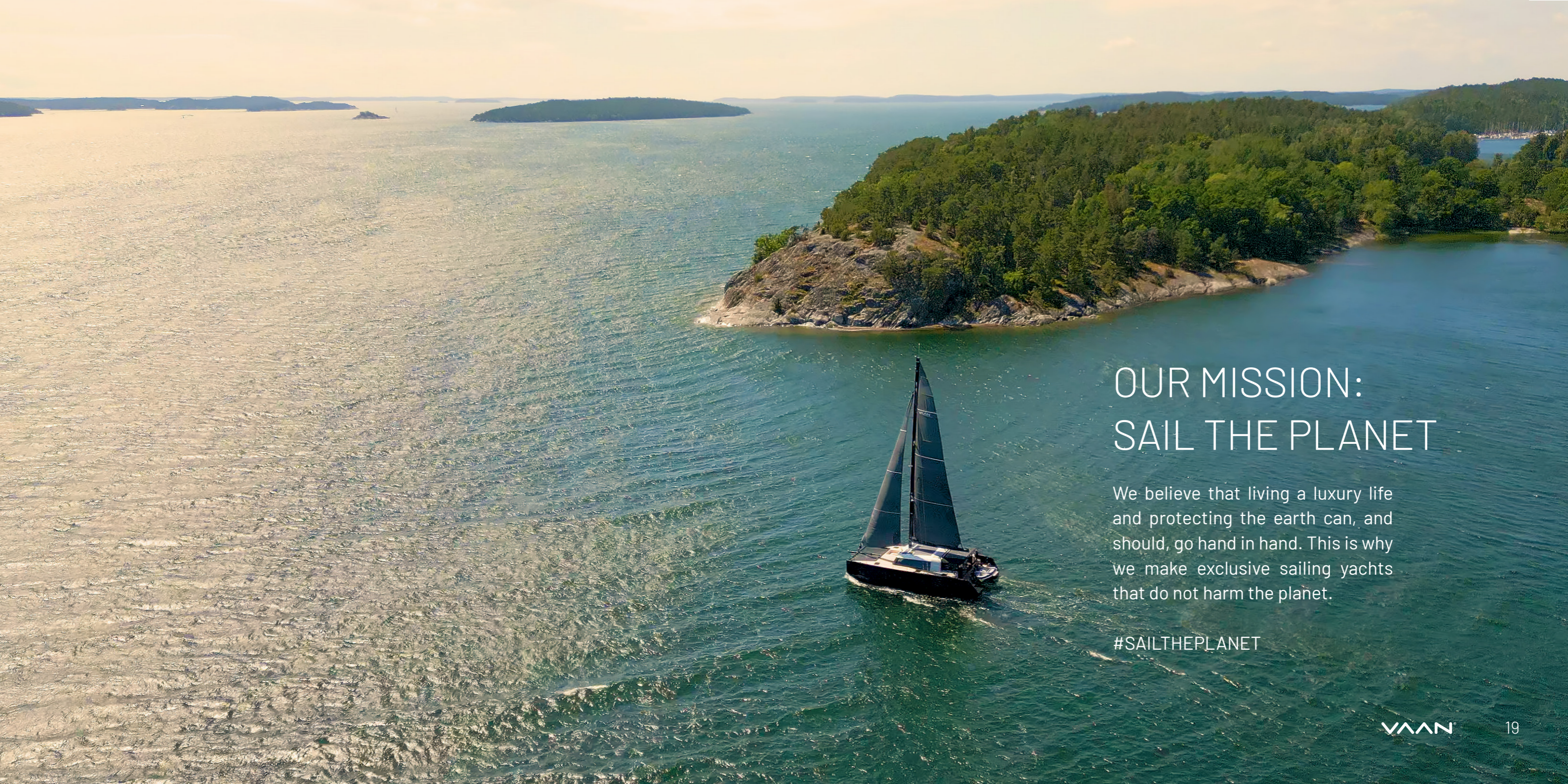

# OUR MISSION: SAIL THE PLANET

We believe that living a luxury life and protecting the earth can, and should, go hand in hand. This is why we make exclusive sailing yachts that do not harm the planet.

#SAILTHEPLANET



## RECYCLED ALUMINIUM

The design of every Vaan is based on circular principles from the start. It is mostly made of recyclable materials and therefore almost completely recyclable at end-of-life.

The hull is made up of over 60% recycled aluminium like old window frames, traffic signs and license plates. Some parts contain even more than 85% so called post-consumer-scrap (PCS).

Aluminium also has an excellent track record for its strength and safety. It makes the hull very rigid, which means no 'cracking' noises inside. And of course the Vaan Vivid Alu has an amazing unique look.



## CIRCULAR MATERIALS

We are committed to use only the best, sustainable materials. The hull is made of recycled aluminium and also elsewhere the finest sustainable materials are used: PEFC certified cork decking, recycled fabrics, FSC certified woods. These choices make a Vaan not only 'circular', they also create a warm, cosy atmosphere. As it turns out, the 'fair' material is usually also the most refined.

#ITSONLYNATURAL #CIRCULARMATERIALS #SUSTAINABLELUXURY  
#SAILING #RECYCLEDALUMINIUM #ALLELECTRIC #SOLARENERGY  
#BIOBASED #LOWIMPACT #TOGETHER #SAILTHEPLANET

## ALL ELECTRIC

Fitting our 'Sail The Planet' mission, a Vaan is all-electric, from induction cooking to electric propulsion. The large or extra large battery banks are charged by the solar panels, the hydro-generating motors, or the wind. A back-up generator can be added to the energy mix to provide extra assurance on longer journeys.

Not only has all-electric less climate impact, it also saves space and eliminates smells, noises and vibration.



*"There is something magical about sailing. Being moved by nature, propelled by the wind, you can go, wherever you want to go, naturally.*

*Sailing makes you humble. At the mercy of the sky and sea, you naturally become evermore respectful of the earth. And mindful of your place in it.*

*For us, sailing is the ultimate sustainable travel. And it's time for sailboats to live up to that.*

*Living a luxury life and protecting the earth can, and should, go hand in hand.*

*This is why we started Vaan. To build exclusive sailing yachts, that do not harm the planet. To restore the balance between pleasure and planet. To enable people to travel to pristine places, without causing negative impact. To protect the beauty of nature and enjoy it at the same time. Sail the Planet!"*

Nienke van 't Klooster & Igor Kluin

Founders Vaan Yachts



# THE VAAN RANGE

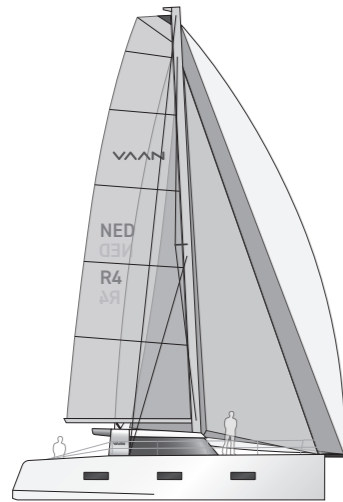

R4

LOA: 42ft/12.80m  
BEAM : 7.06m

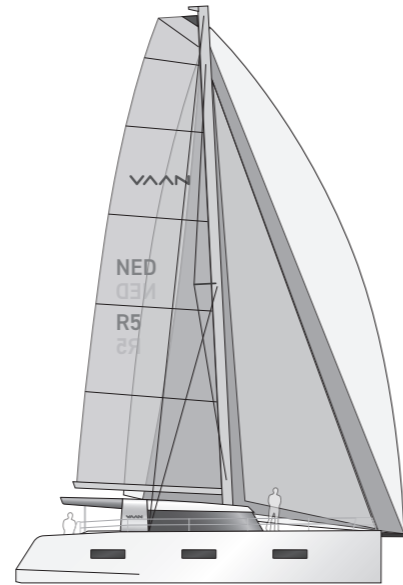

R5

LOA: 49ft/14.95m  
BEAM : 7.99m

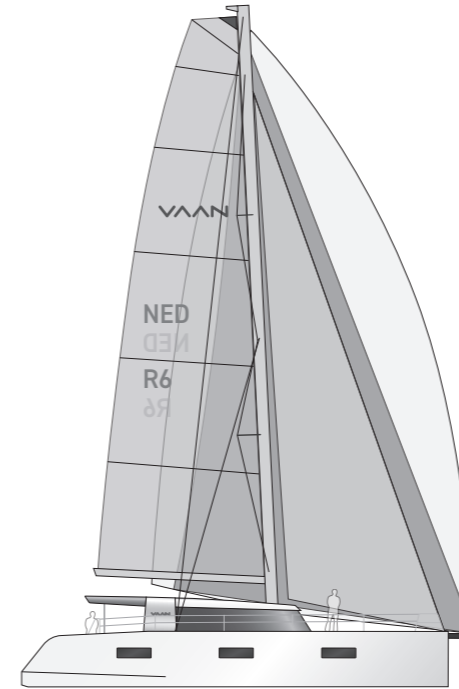

R6

LOA: 58ft/17.68m  
BEAM : 9.03m

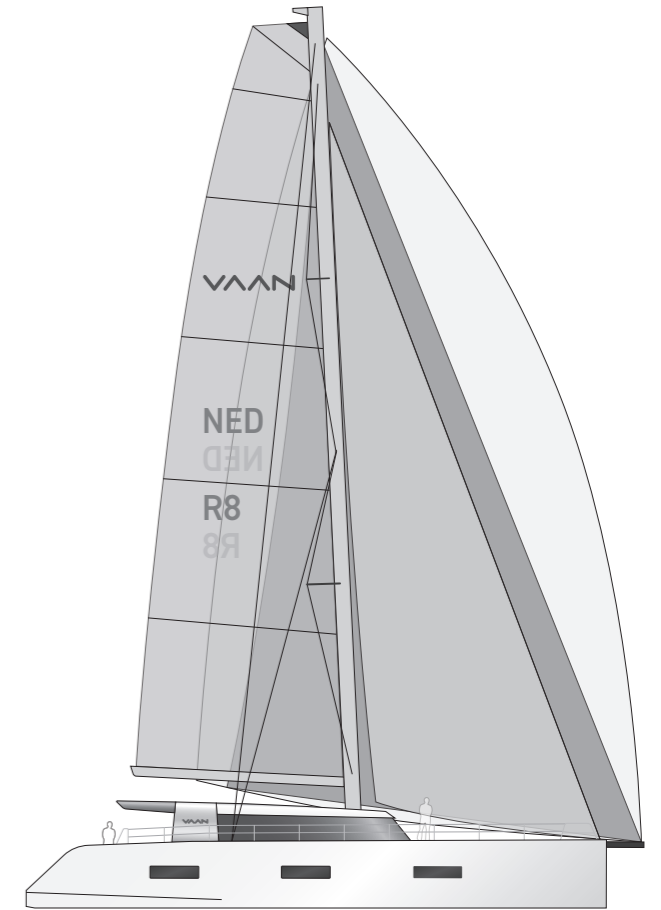

R8

LOA: 78ft/23.80m  
BEAM : 11.00m





Q160356\_BN  
Q10727  
VT2250



## THE ULTIMATE DECK SALOON

The R4 is designed for sailors who are looking for a very easy to handle yacht for smaller marinas. Offering the same attention to quality and detail as the larger models, the R4 delivers the grand Vaan experience in a smaller form factor.

# R4



# THE RIGHT HELM POSITION

As a helmsman you want to be at the back of the cockpit, where you have the best view of the sails and the full hull. The large, open transom of the R4 connects you to the water that rushes underneath.

It gives you a spectacular sailing sensation. Much like a monohull but without the heeling, and faster. And because of the dual helm positions and the optional bimini, you can always be sheltered and safe from the elements.



## CAT CABRIOLET

Unlike most cats, the Vaan R4 does not have a large, fixed roof all over the cockpit. Instead, we created a bimini that can be installed and removed in a matter of minutes.

People in the cockpit and at the helm can be protected from the sun when desired. But for colder regions, steering in the sun is also possible. It makes the R4 great for going south, as well as for a trip up north. Please check the options section for all roof options.



## THE SALOON LIVING ROOM

The saloon has a bright, warm and welcoming feel to it. The modern and functional kitchen is light yet solid and offers all the amenities to really enjoy some good cooking.

## SPACE & STORAGE

The R4 port-side owners hull offers 4 generous full width and depth closets to store your clothes. The optional dresser offers additional drawers for your accessories. The hallway is intentionally left as open as possible. Because as we all know, space is the true luxury.



# COCKPIT & SALOON

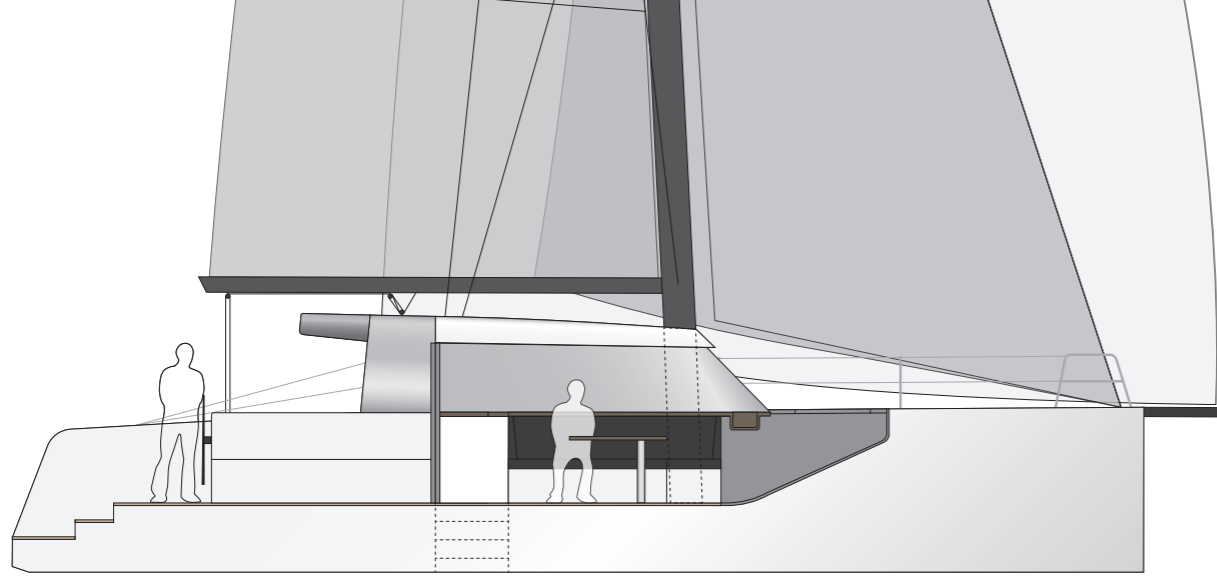
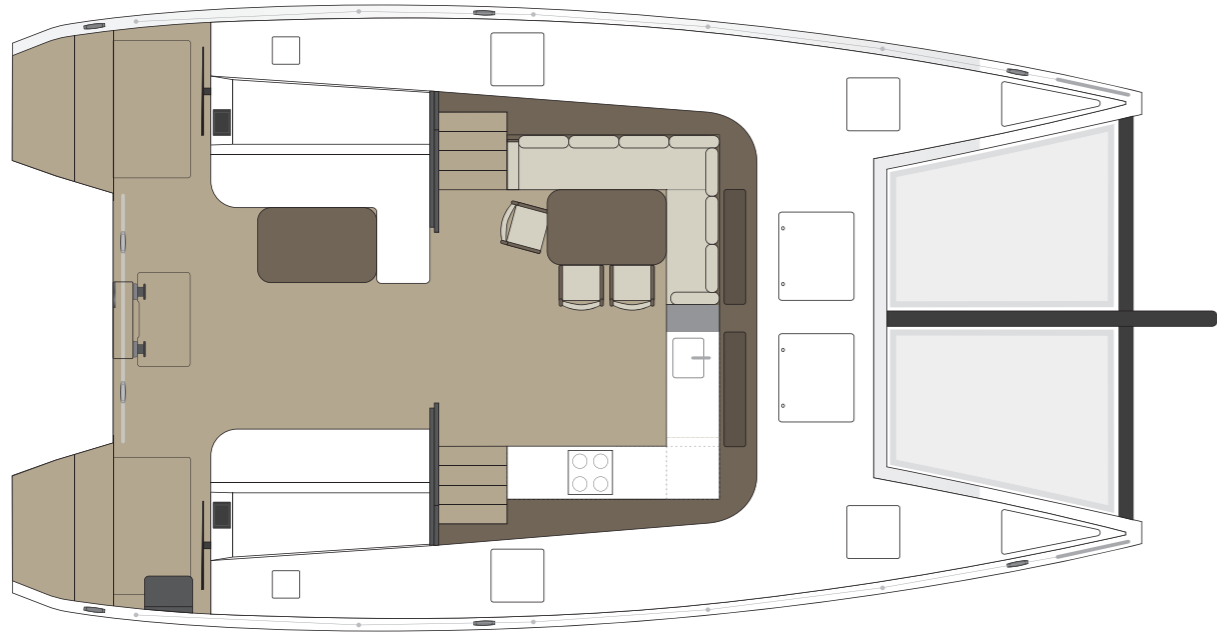

# HULLS

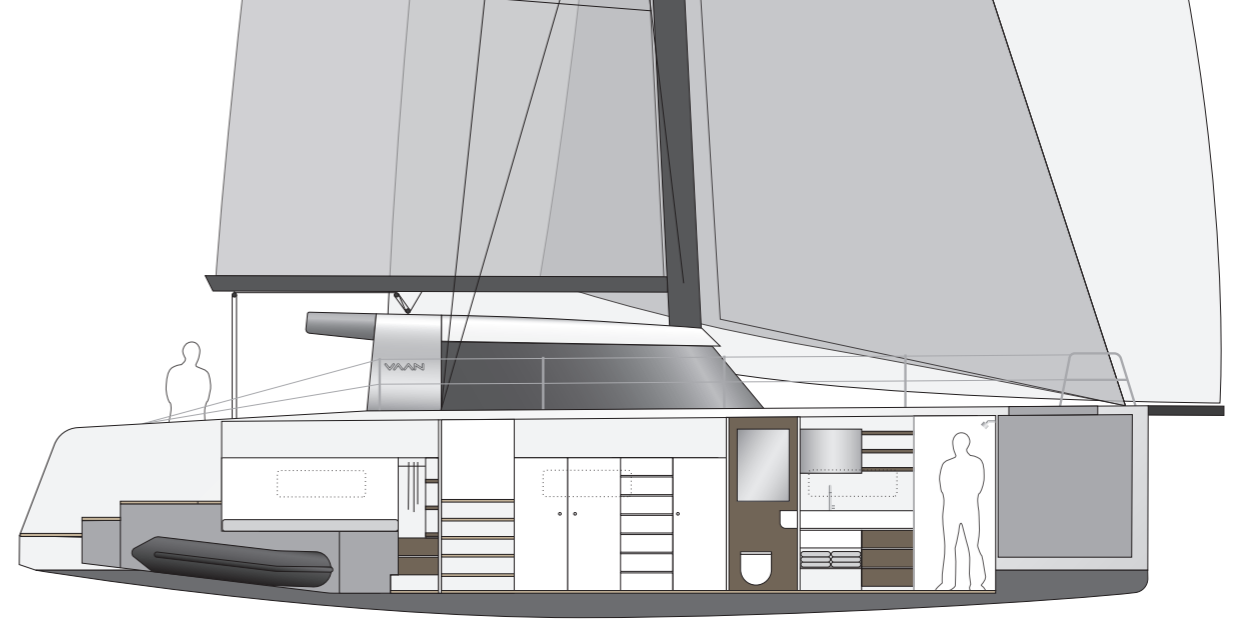
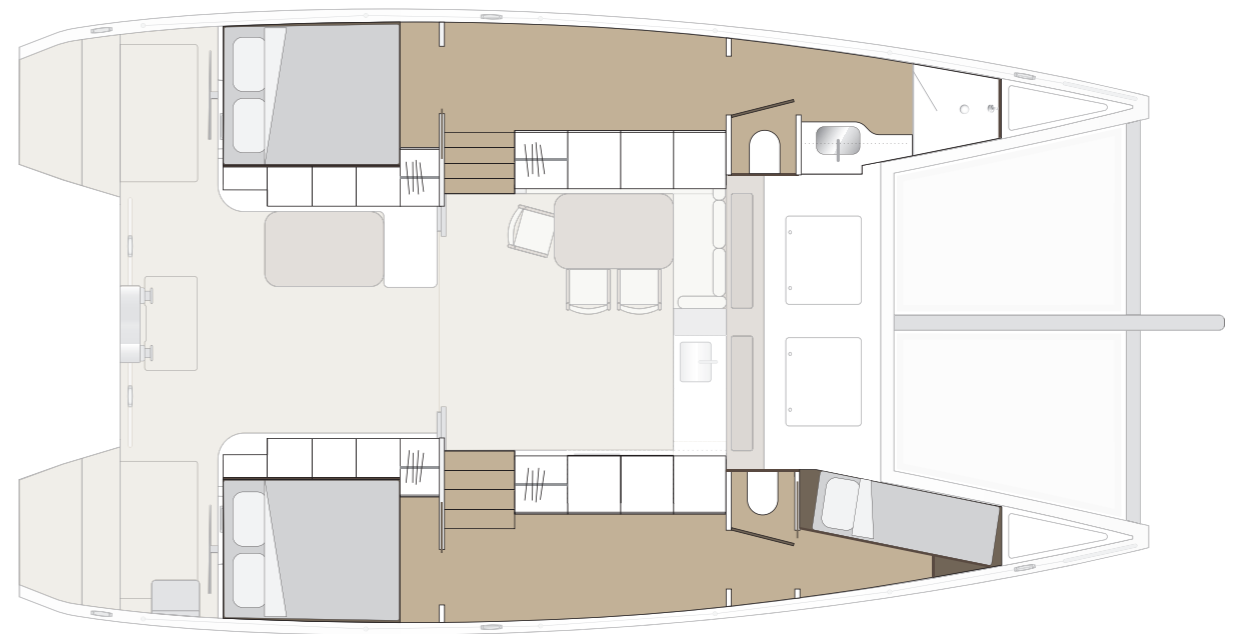

# LAY-OUTS

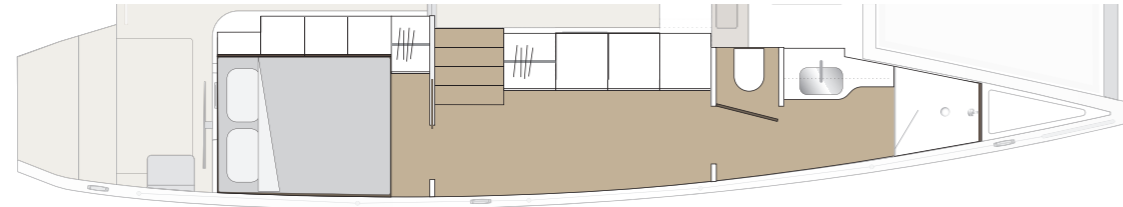

Extra Master Bed

Second Large Bathroom

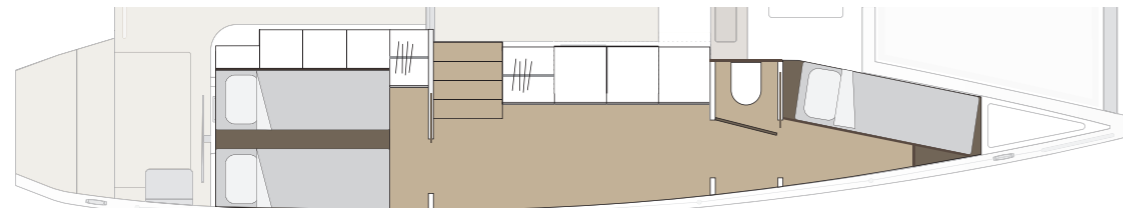

Sliding Double Bed

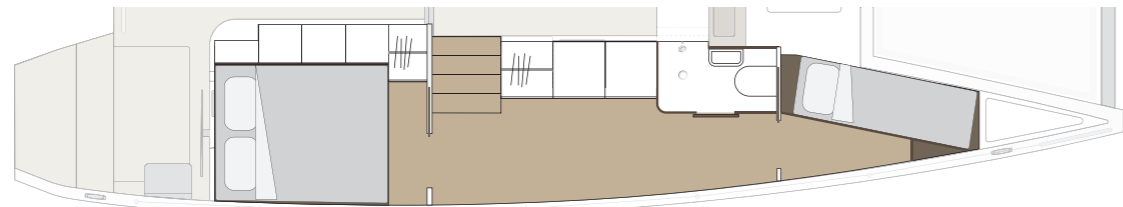

Mid Bathroom

The plans, specifications, images and other details herein are only indicative and subject to change.

# DRESSER

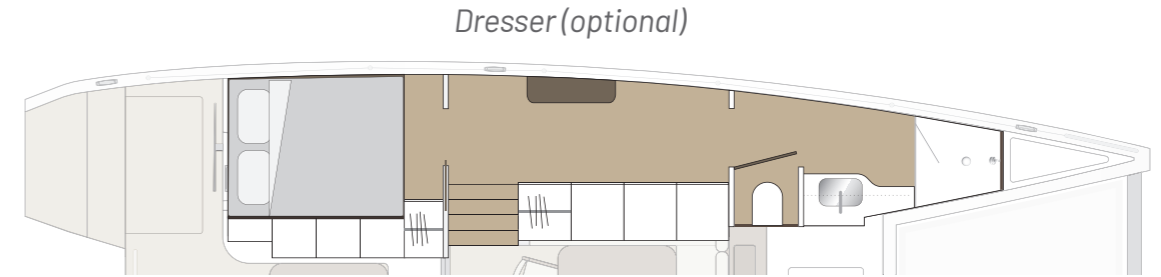

Dresser (optional)

The guest hull offers subtle different options. It features a twin bed that can easily be moved together to form a double bed. It has its own separate toilet and several options for the front cabin: bunk-beds or a full-sized second bathroom.

Optionally you can also design your own starboard forward cabin. A gym? An office? A tool shop? Let us know your ideas and we'll make it happen.

## OCEANVOLT

- 2x SD15 saildrive
- Power: 2x 15kW  
(similar to 2x 25Hp combustion)
- Hydro Generation:  
up to 2x 1kW (standard)  
up to 2x 2.5kW (servo-prop)
- MG LFP batteries  
21 or 42 kWh
- Optional generator: 15kW



# SPECIFICATIONS



- Main : 55 m<sup>2</sup>
- Jib (ST) : 30 m<sup>2</sup>
- Gennaker : 135 m<sup>2</sup>
- Code-0 : 85 m<sup>2</sup>

← 12.80m / 42ft →  
Displacement: 10,9T

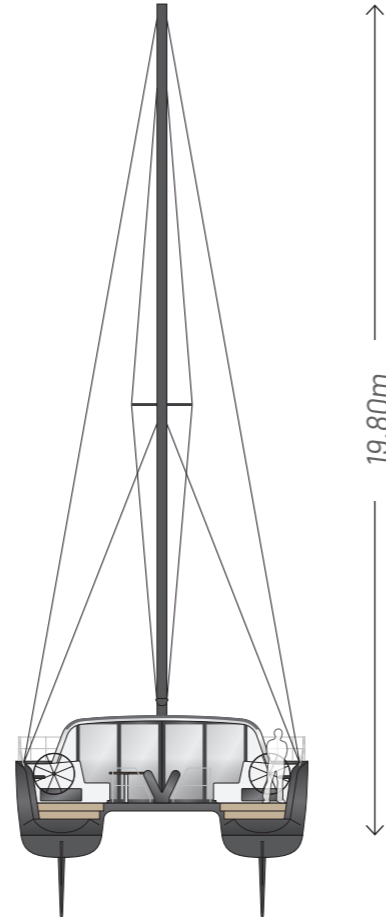

← 7.06m →

# POLAR DIAGRAM

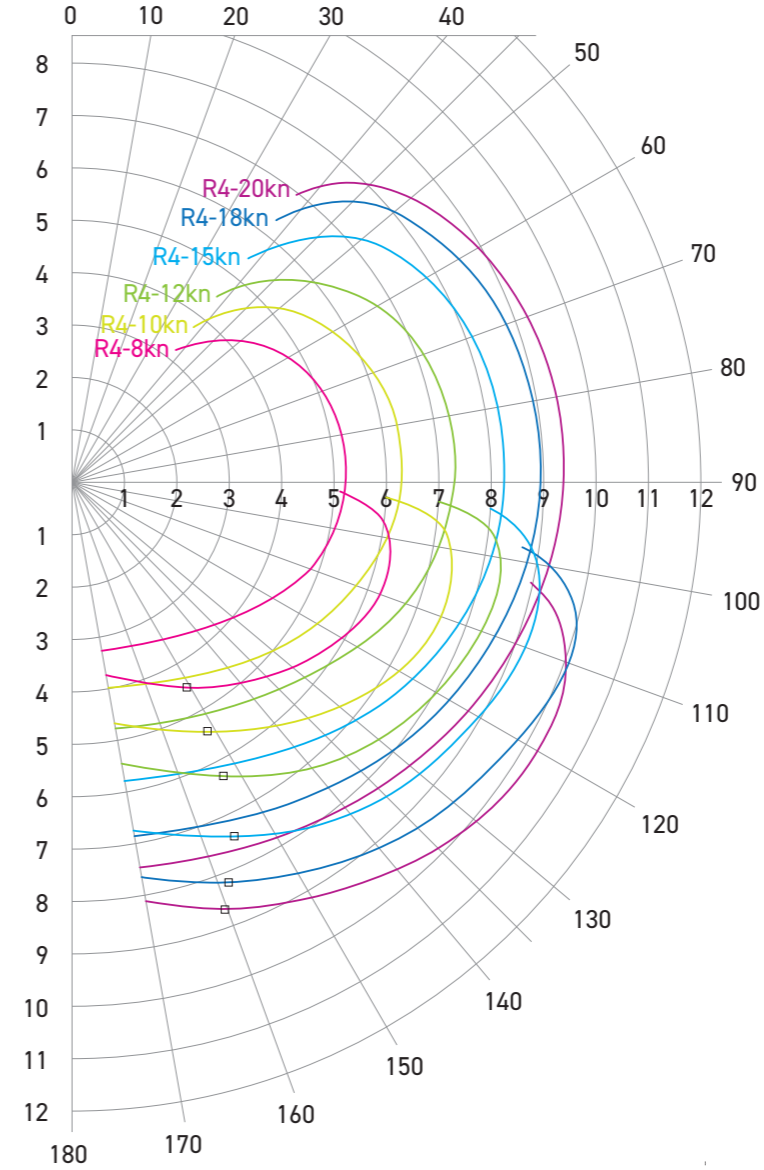

- VAAN R4**
- Loa: 12.80m (42ft)
  - Beam: 7.05m
  - Sail area upwind: 85m<sup>2</sup>
  - Sail Area Downwind: 190m<sup>2</sup>

- VPP CALCULATION**
- By Dykstra Naval Architects
  - Max RM 100kNm

- AERO**
- Coefficients from Windesign
  - No reefs
  - Flat internal method
  - Windspeed at masthead
  - Windangle relative to tack

- HYDRO**
- CFD calculation
  - Calculation run for flat water

## THE R4X4

Its tough, rugged aluminium hull, combined with the refined glossy deck and coach roof, make the Vaan R4 feel like a luxury off-road car. It will withstand extremes, conquer rough terrain and bring you wherever you want to go, all in a very comfortable and stylish fashion. Why compromise.



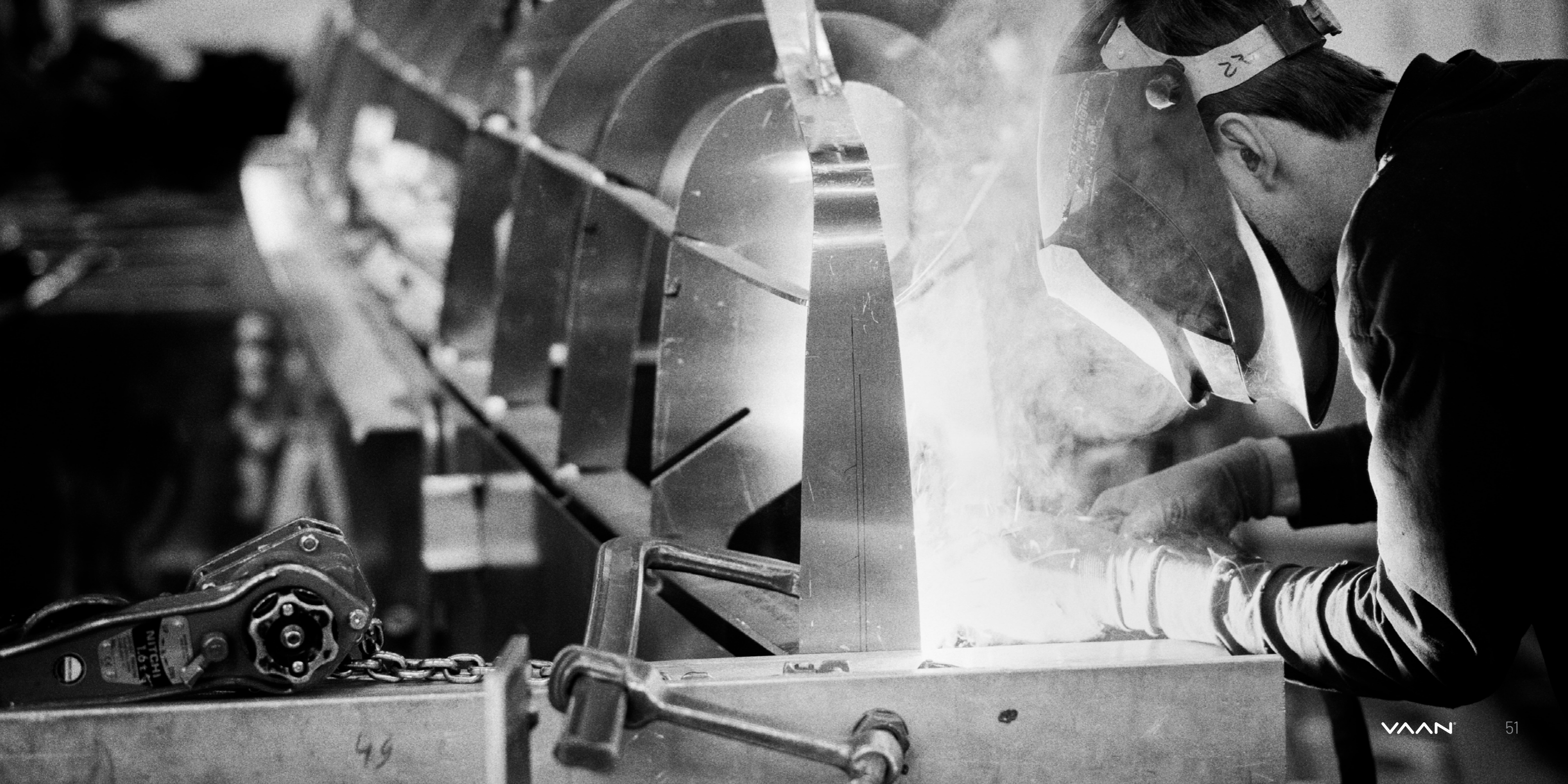

# GO THE DISTANCE

At 49ft the Vaan R5 really goes the distance. A luxury platform to explore the most distant places and faraway islands. A spacious sailing machine for couples to large families.

# R5



The image shows the interior of a luxury sailing catamaran. The space is bright and open, with large windows on all sides offering a panoramic view of a blue body of water and a distant shoreline with green trees. The interior features light-colored wood paneling on the walls and ceiling. A central kitchen area is equipped with white cabinetry, a stainless steel countertop, a sink, and a built-in oven. A large, dark green cylindrical pillar stands in the middle of the deck. To the left, there is a seating area with light-colored cushions and a white table supported by metal legs. The floor is covered in a light brown carpet. The overall atmosphere is one of modern elegance and spaciousness.

## LIVE ANYWHERE

The open spaciousness of the R5 transforms this sailing cat into your penthouse on the water. Even with a family of six you can spend years exploring the planet. The home-size kitchen with ample storage allows for cozy cooking sessions together.



## LOOK THE PART

Whether you choose your hull finish in Vaan Vivid Alu, Snow White, Stone Grey or Lava Black, a Vaan will stand out from the crowd wherever you go.

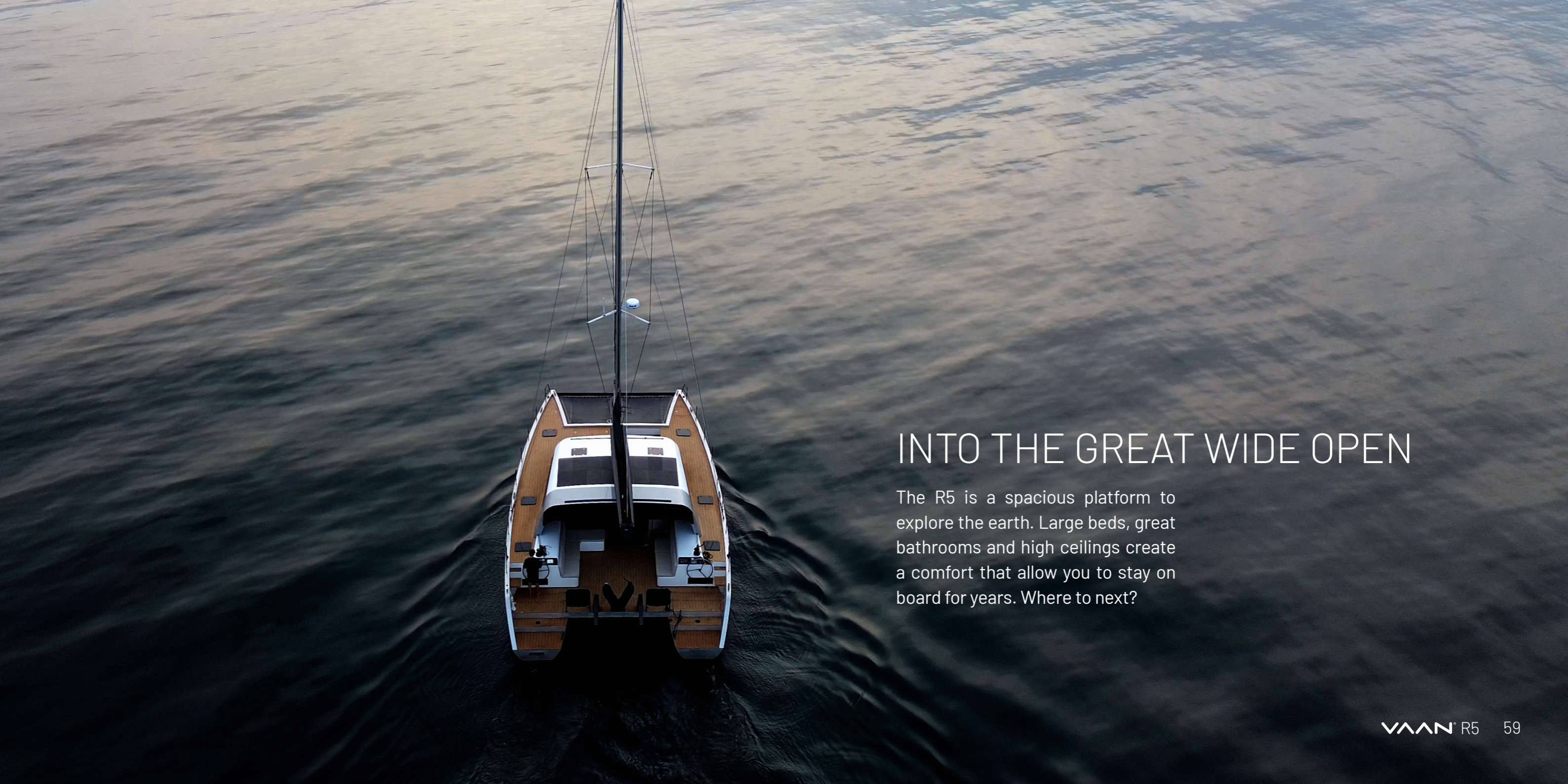

## INTO THE GREAT WIDE OPEN

The R5 is a spacious platform to explore the earth. Large beds, great bathrooms and high ceilings create a comfort that allow you to stay on board for years. Where to next?



EXTERIOR

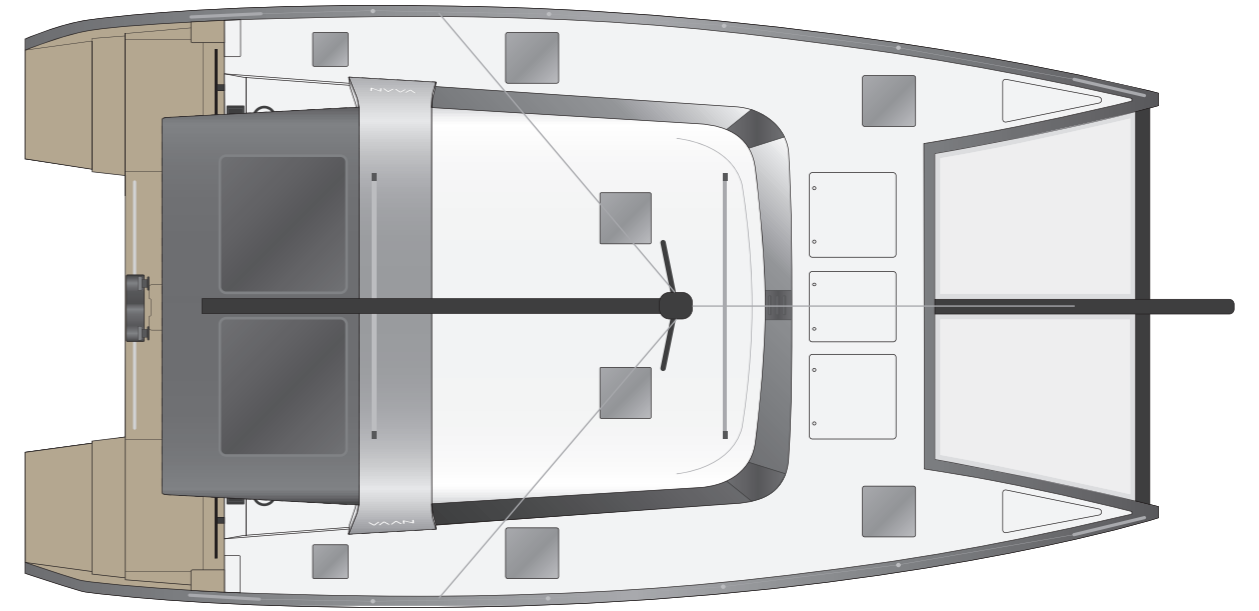

# COCKPIT & SALOON

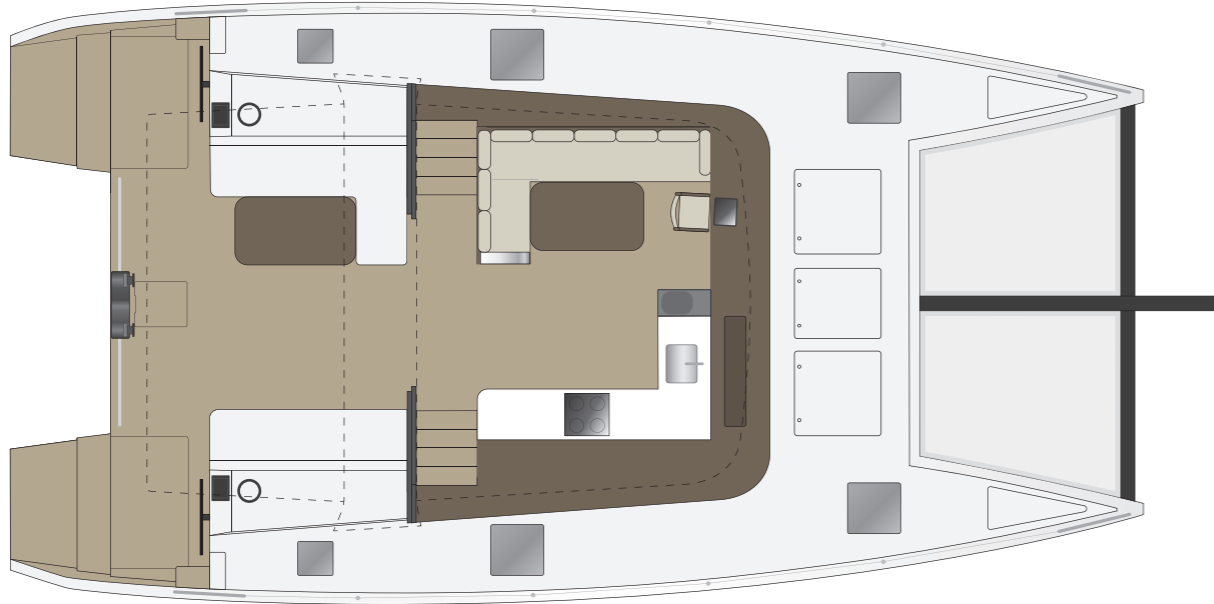
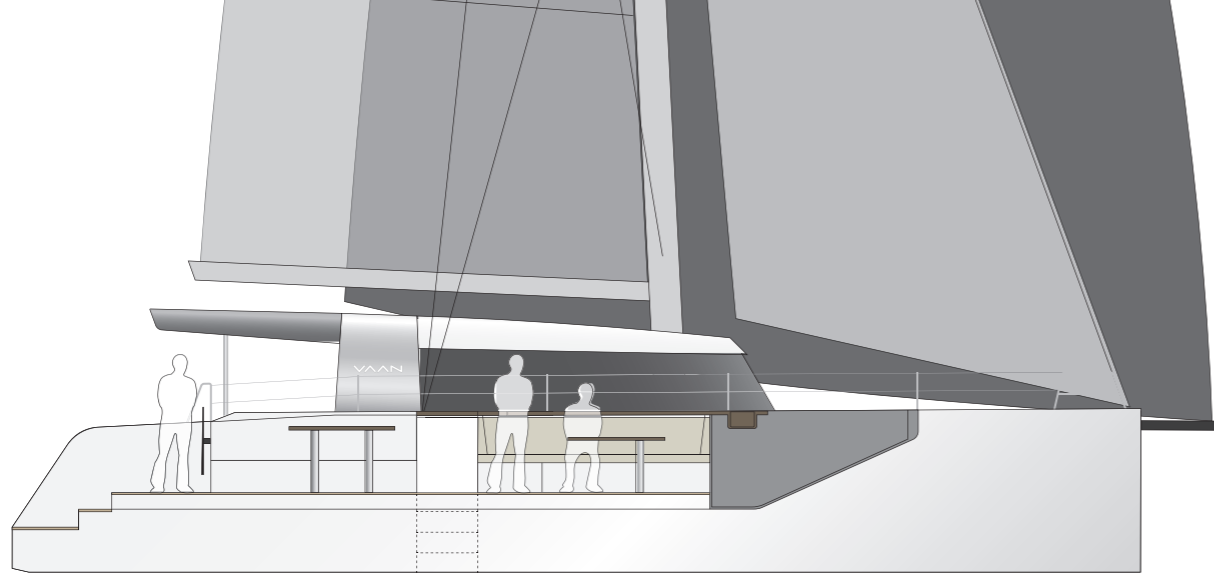

# THE OWNERS SUITE

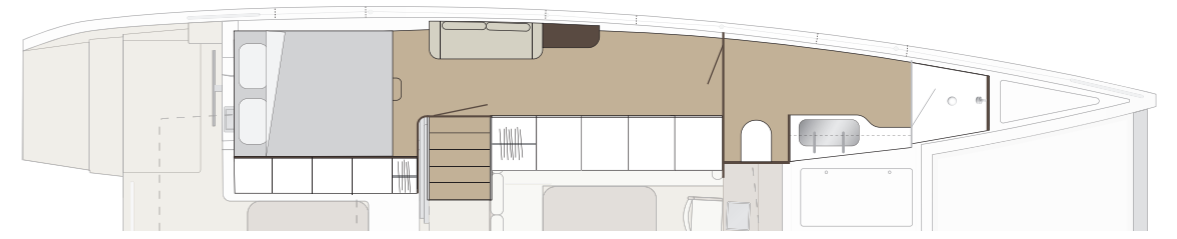
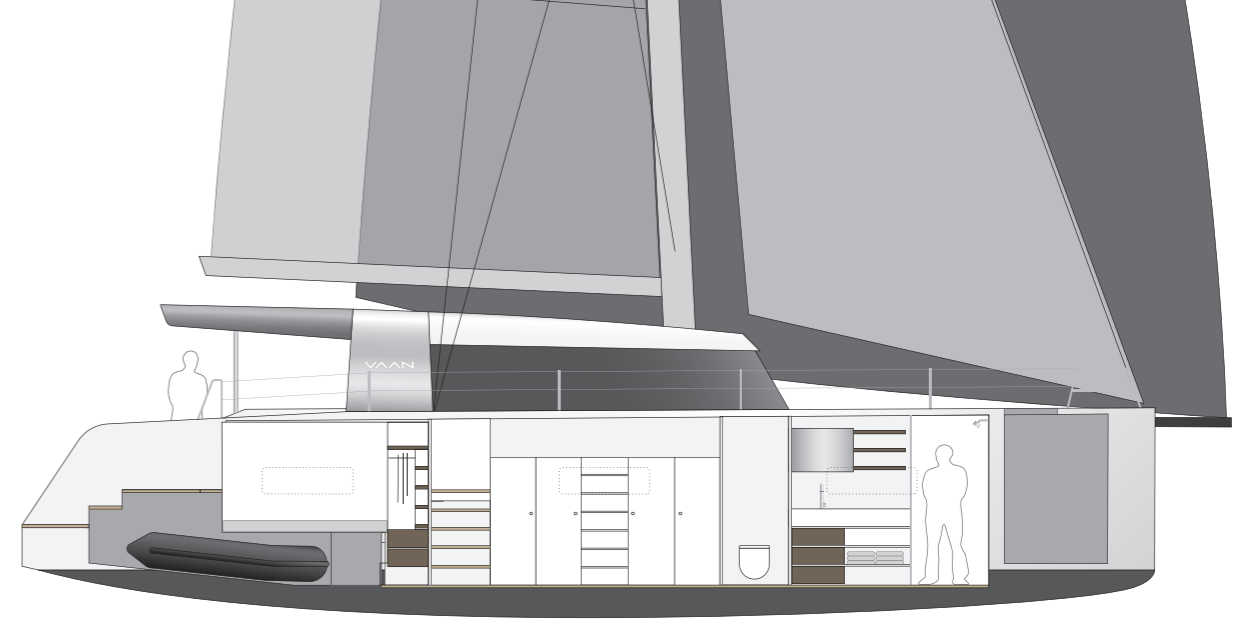



## MOVING FORWARD

The optional forward seating area offers a nice cooling breeze while at anchor. Or a beautiful sunrise view while you're having your first cup of coffee.

The table can be raised to provide seating for 3-4 people, or lowered to offer a large lounge bed. And why not fill the bottom section with some ocean water for the kids to play in or for you to cool off in? Hello jacuzzi:)

LAY-OUTS

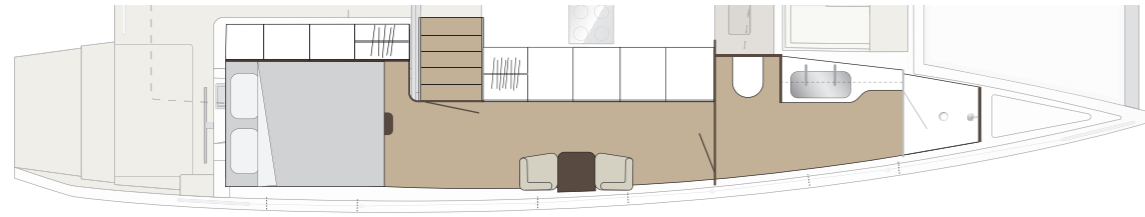

Second master suite with walk-in closet and full bathroom

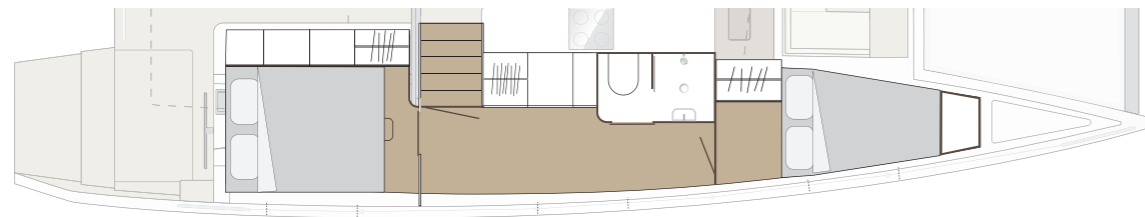

Aft bedroom

Mid Bathroom

Tripezium Bed

OPTIONS

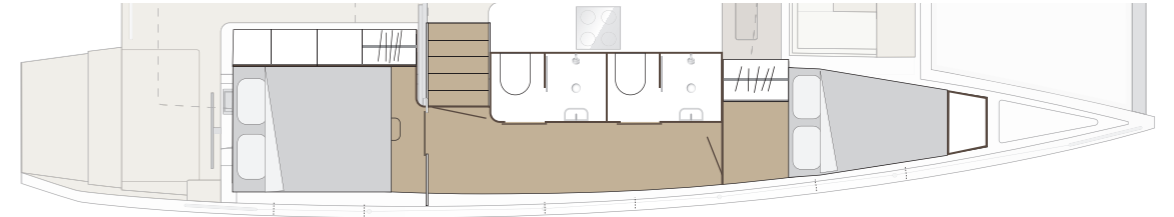

Double Mid Bathroom

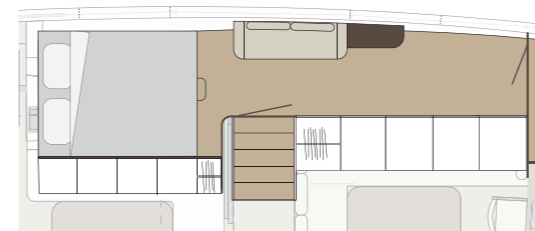

Sofa + Dresser

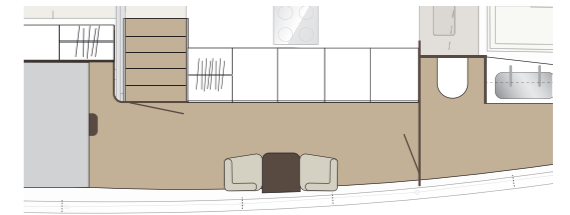

Table with Seats



## MOVED BY NATURE

All that space, all that comfort, is matched by the R5's sailing qualities. This is a true sailing yacht that is ready to go anywhere, both in light winds and strong ones. The wind in your face, a little splash of water, the sails feeling powerful. Sailing at its best.

## TORQUEEDO

- 2x Deep Blue saildrive
- Power: 2x 25kW  
(similar to 2x 40Hp combustion)
- Hydro Generation: no
- 40-80 kWh batteries
- Optional generator: 15kW



## OCEANVOLT

- 2x SD15 saildrive
- Servoprop option
- Power: 2x 15kW  
(similar to 2x 30Hp combustion)
- Hydro Generation:  
up to 2x 1kW (standard)  
up to 2x 2.5kW (servo-prop)
- MG LiFePO4 batteries  
40 or 80 kWh
- Optional generator: 15kW



# SPECIFICATIONS

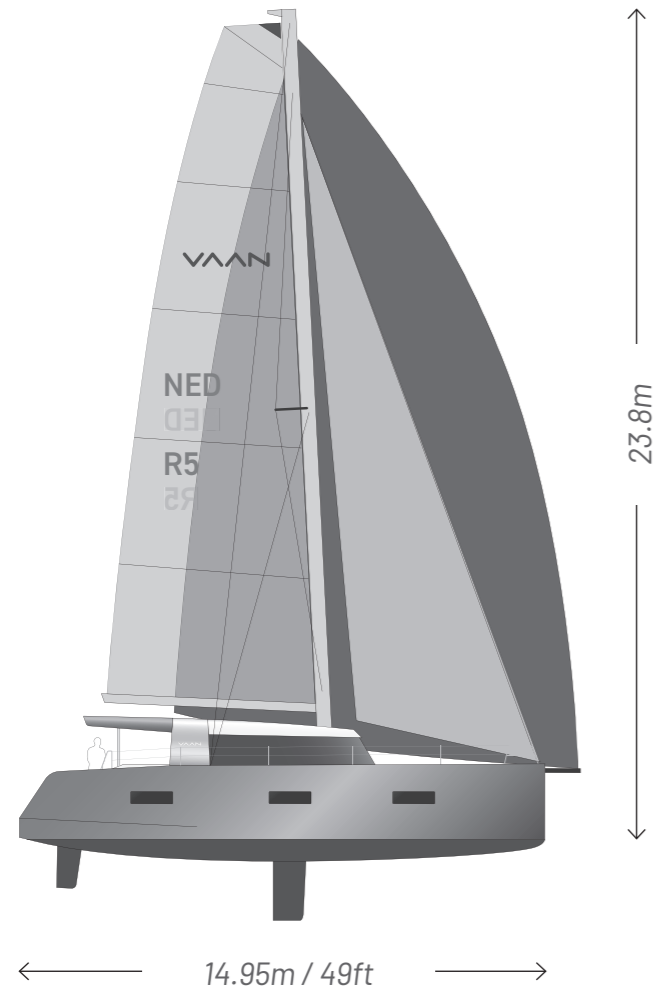

## SAIL AREAS

- Main : 80 m<sup>2</sup>
- Jib (ST) : 45 m<sup>2</sup>
- Gennaker : 170 m<sup>2</sup>
- Code-0 : 120 m<sup>2</sup>

# POLAR DIAGRAM

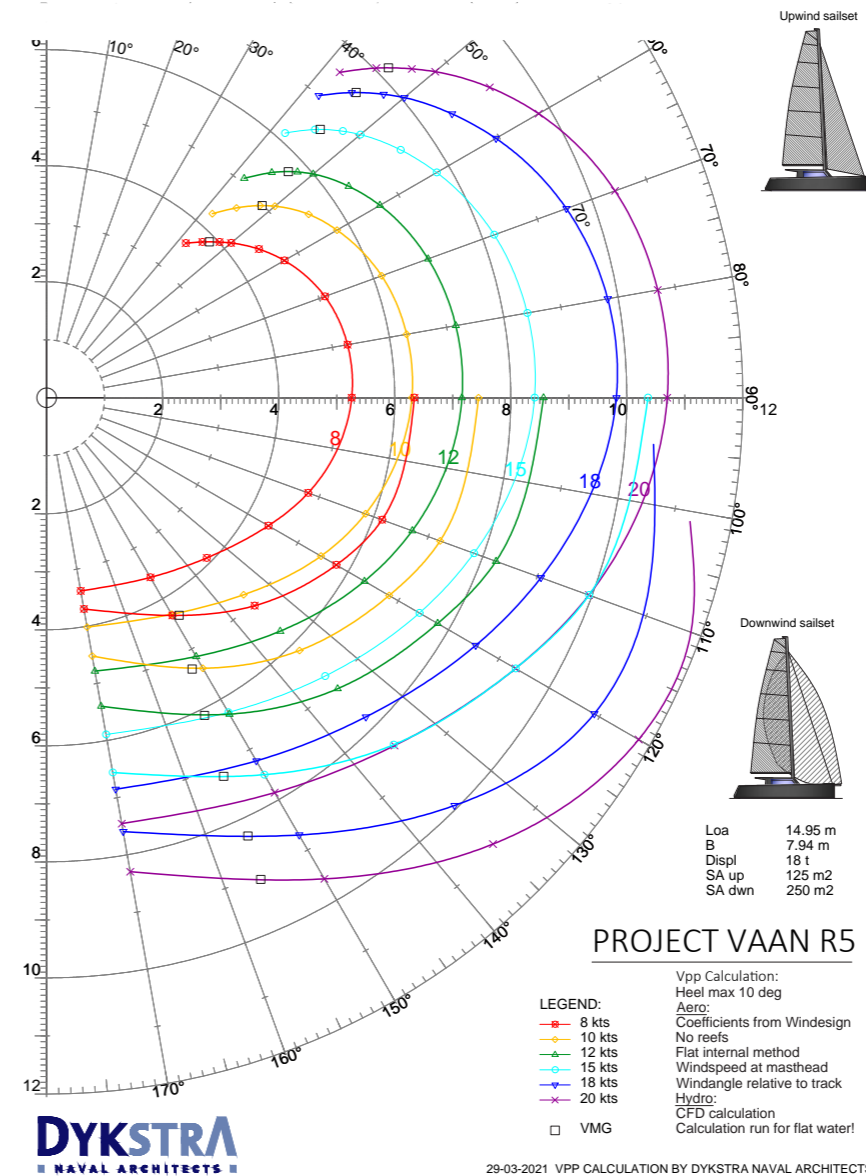

PAF20A-2

PAF20A-2

PAF20A-2

400PS-20A> 1.3  
-5-

400PS-20A>

PAF20A-3

PAF20A-3

PAF20A-3

PAF20A-3

PAF20A

PAF20A

# THE GRAND R6

At 58ft the Vaan R6 is the next step in sustainable luxury sailing. An owner's yacht with incredible space, storage and stability. Made from our strong signature aluminium, with cork decking and electric propulsion the R6 is a truly exclusive sailing yacht.

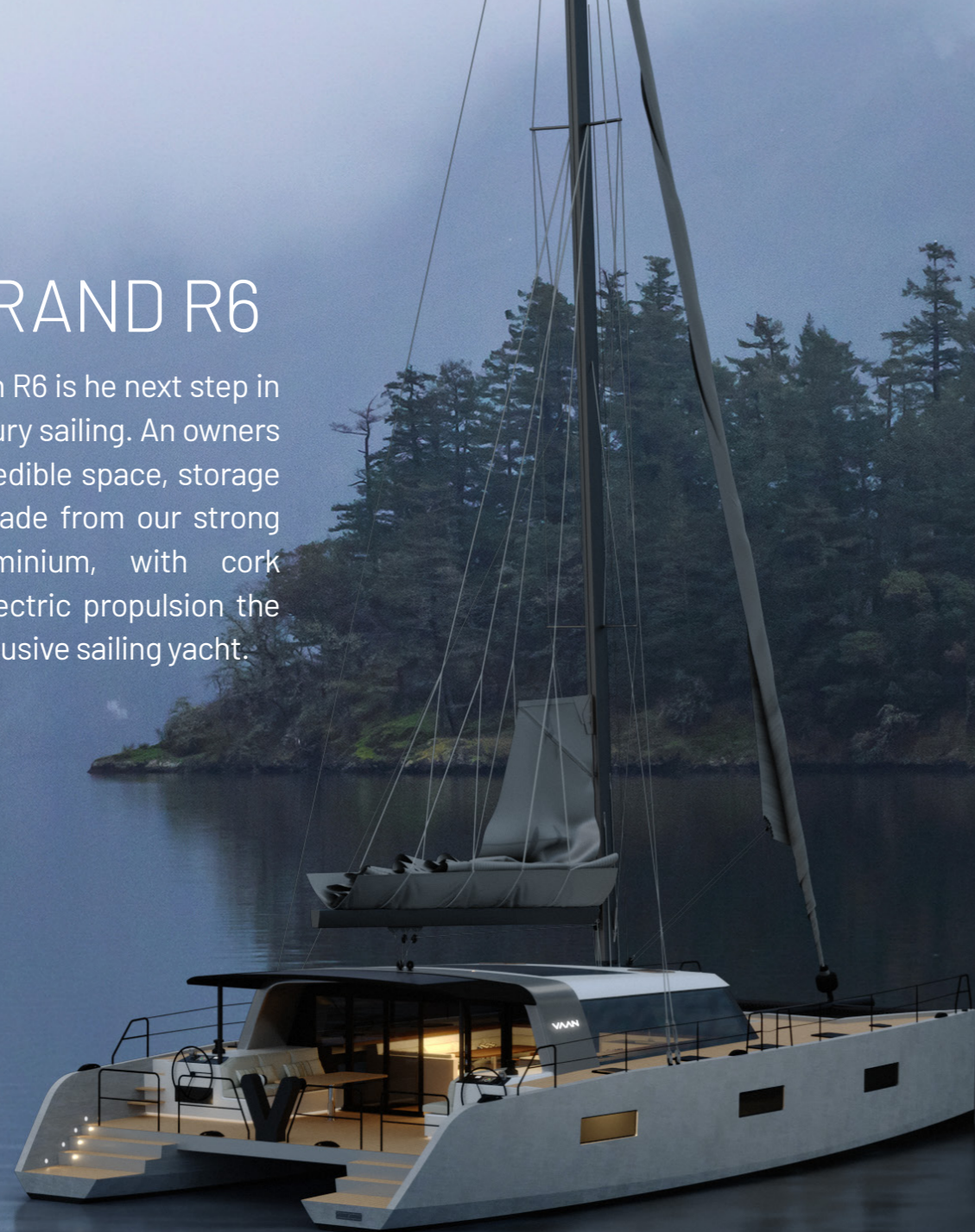

# R6



YOUR ONLY FOOTPRINT  
WILL BE THE ONE  
ON THE BEACH



# TOGETHER OR CREWED

The R6 can easily be sailed by just two people, so you can experience ultimate privacy on your trips. The R6 also offers layouts for crewed voyages with 2 extra beds for the crew providing a maximum of 8+2 berths.





## NEXT LEVEL REMOTE WORKING

Working on a new venture? Writing a novel? Checking in with your management team? The R6 gives new meaning to the term 'remote working'. Equipped with Starlink, you can be in the middle of the ocean and conduct business as usual. Why ever go back?

# UPPER DECK

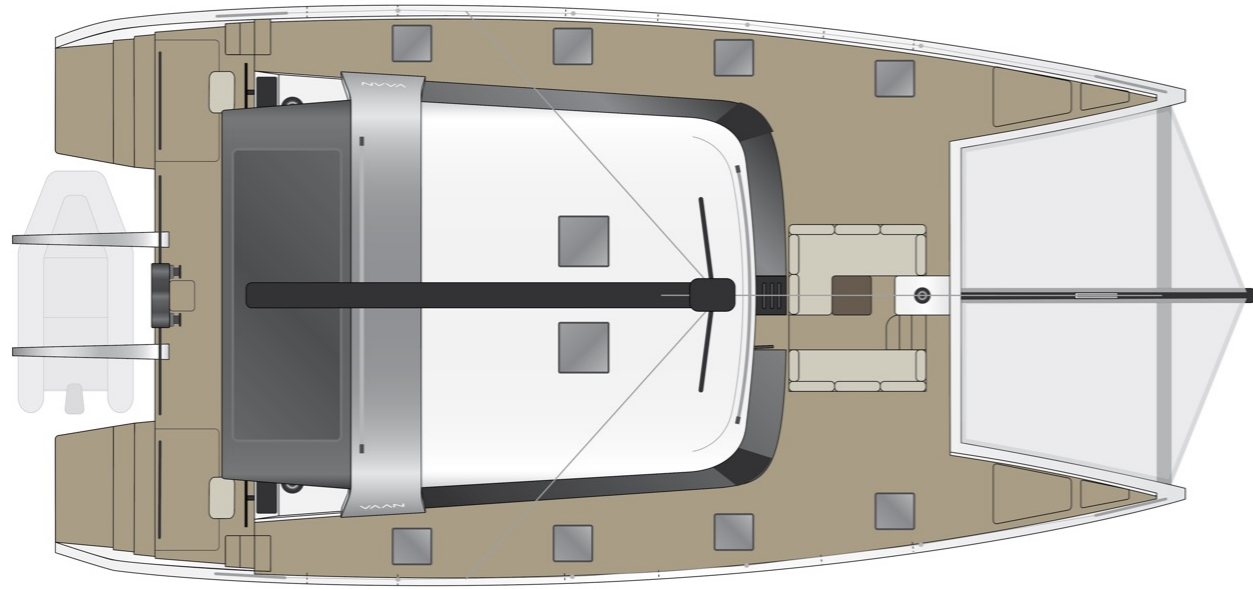

# SALOON

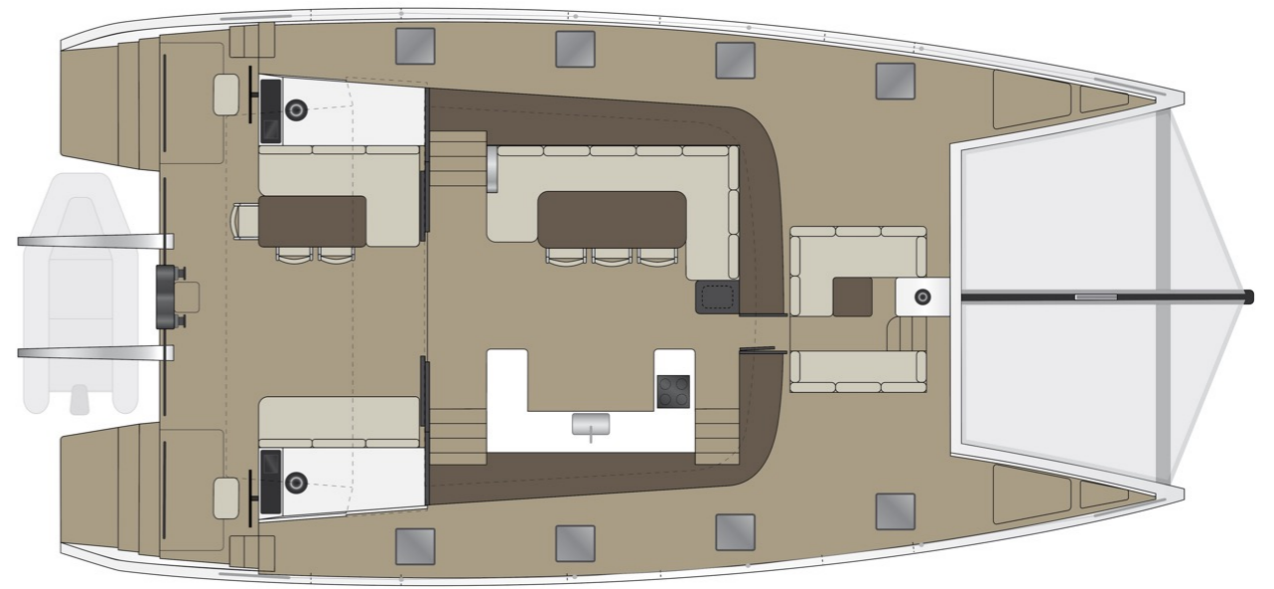

# KITCHEN XL

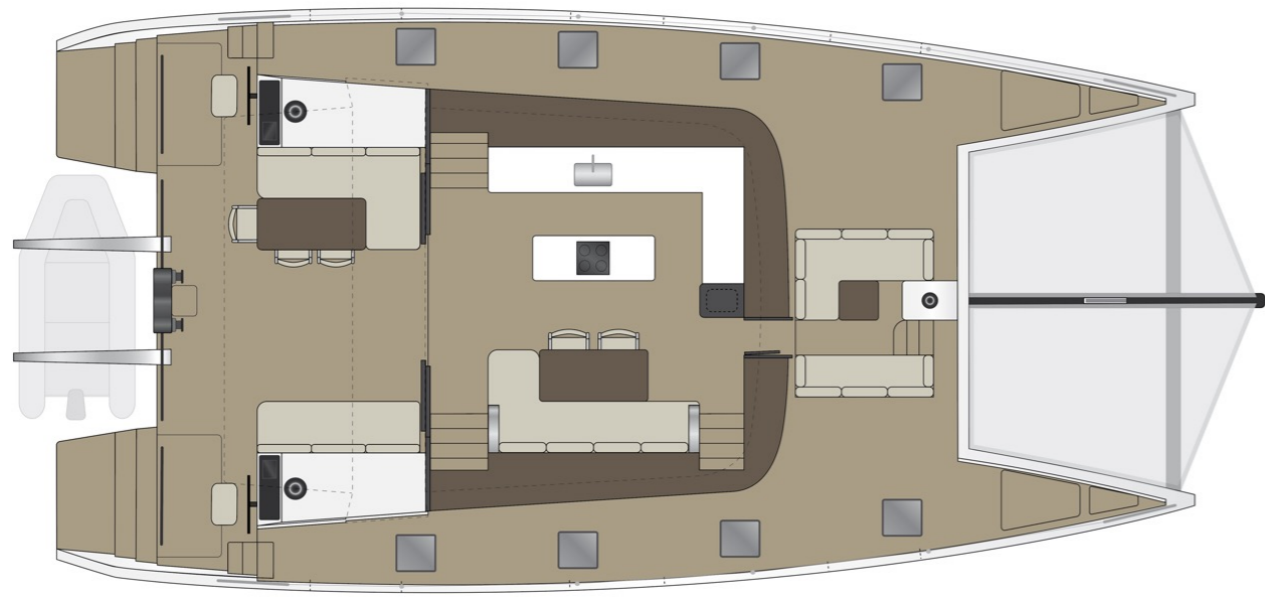

# EXTRA PS STAIRS

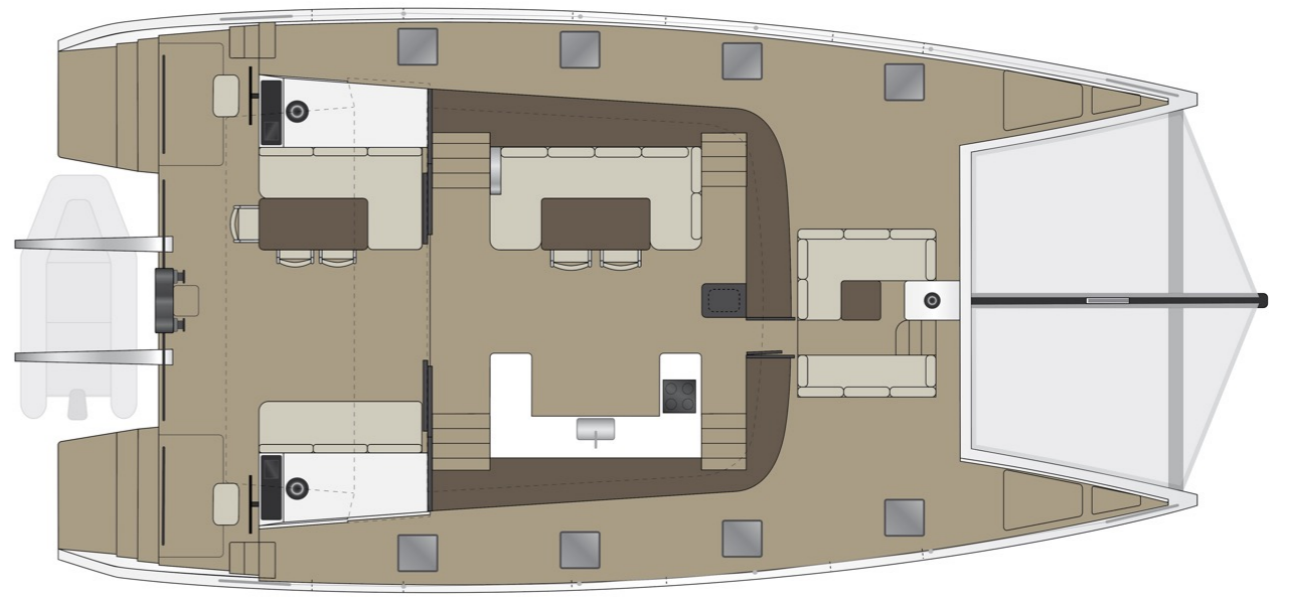

# FROM GREAT TO GRAND

The value of space can not be expressed in numbers. But rest assured that the incredible floor space of the saloon, the wide open cockpit, and the direct acces to the forward seating area will feel simply grand.

HULL LAY-OUTS

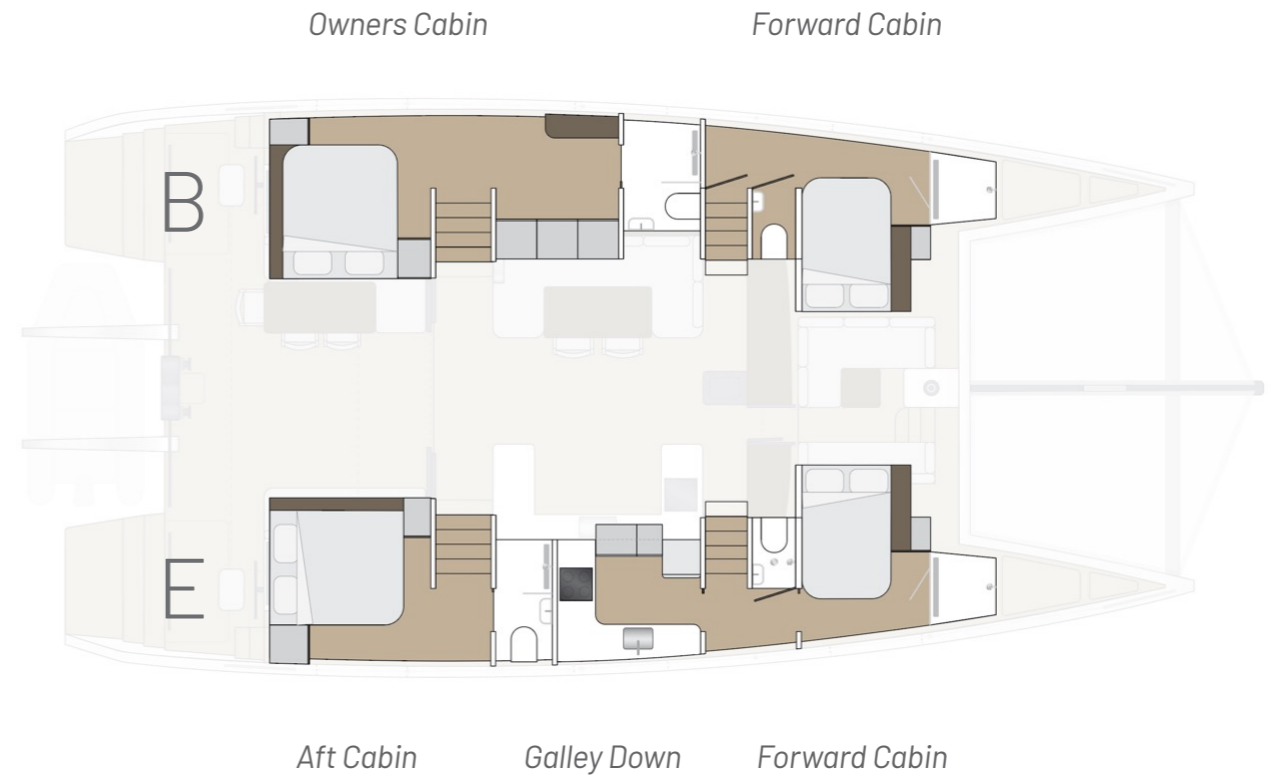
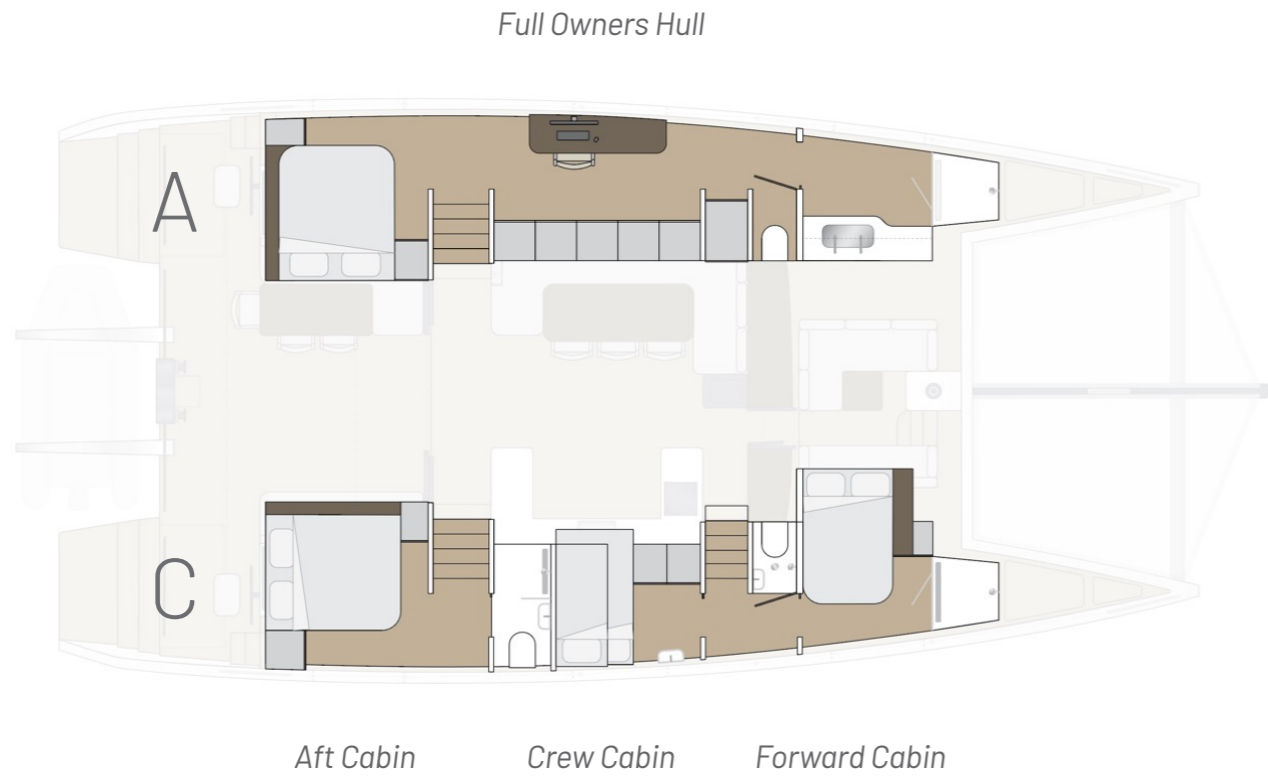

# DIMENSIONS

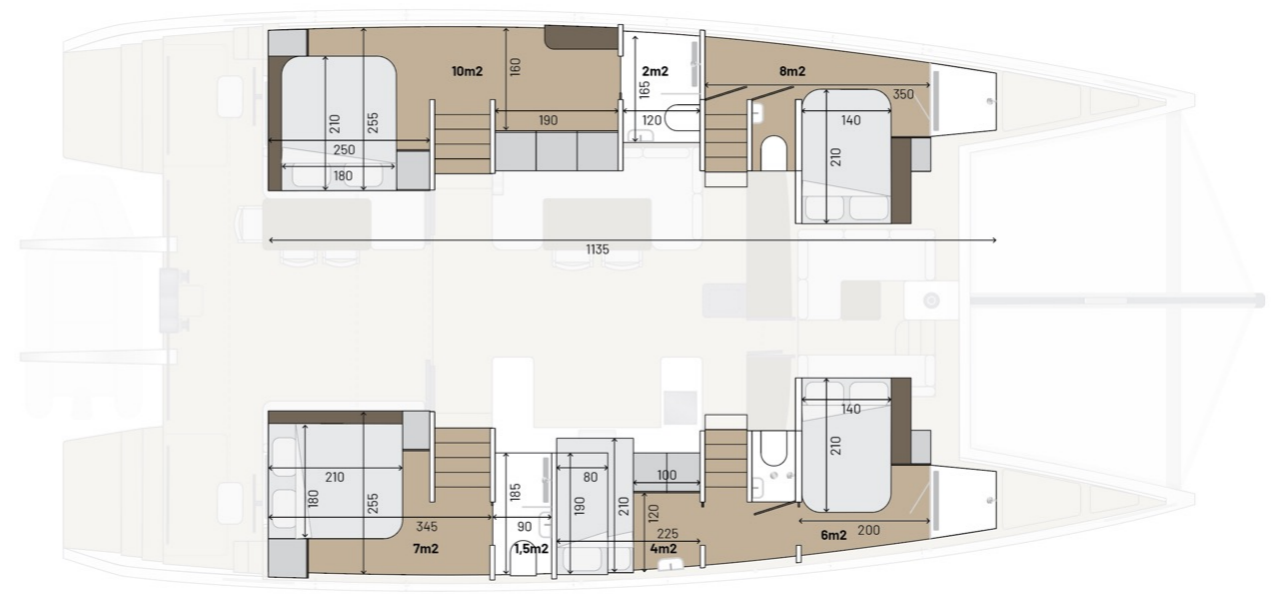
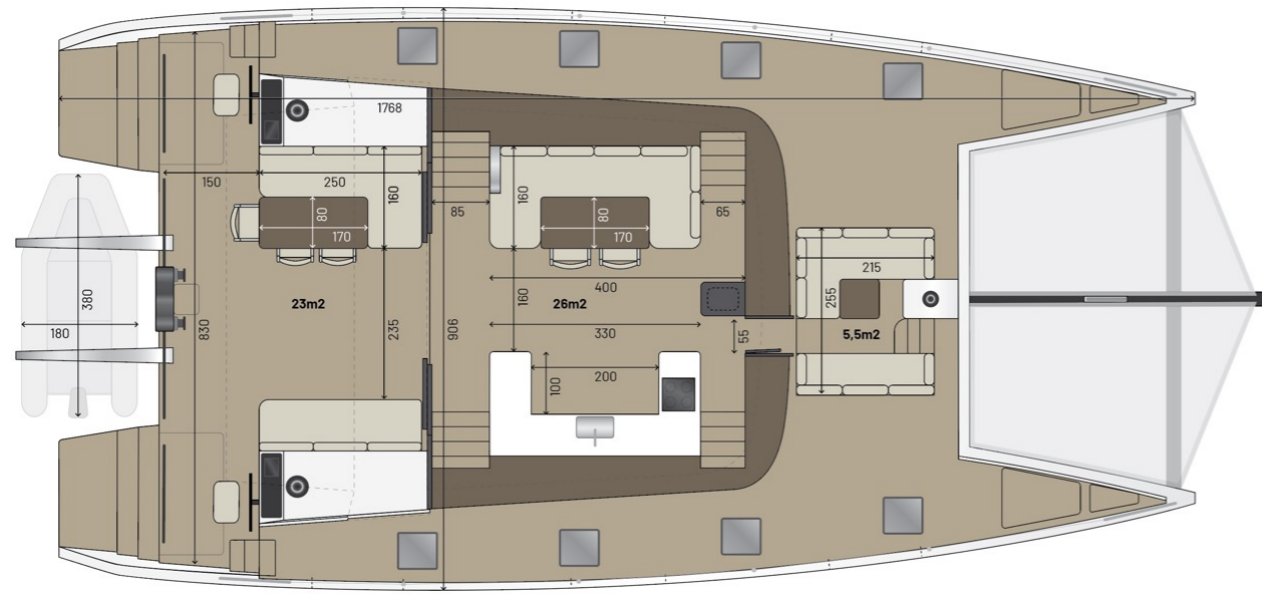

# SOLAR

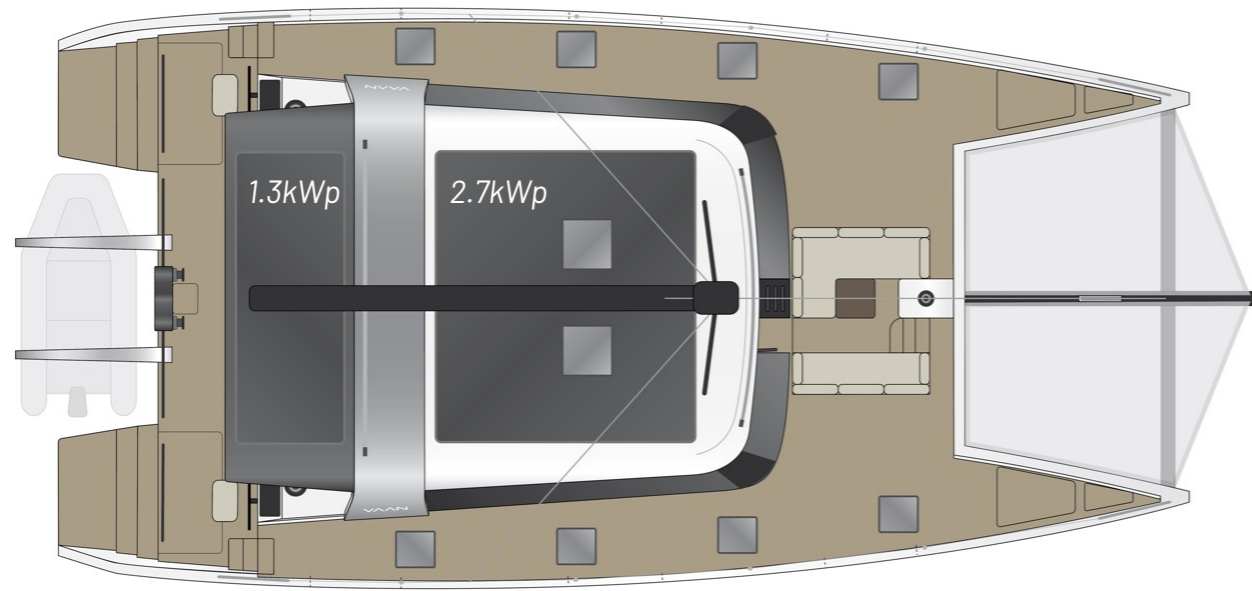

# SPECIFICATIONS

## MAIN DIMENSIONS

- LOA: 58ft / 17.68m
- BEAM: 9.08m
- MAST: 27.50m
- DISPLACEMENT: 22.5t
- BRIDGE DECK: 95cm

## SAIL AREAS

- Main: 110m<sup>2</sup>
- Jib: 65m<sup>2</sup>
- Code-0: 150m<sup>2</sup>
- Gennaker: 200m<sup>2</sup>

## PROPULSION

- 2x OCEAN VOLT HPSP25 saildrive
- Power: 2x 25kW
- Solar 1.3kWp to 4.0 kWp
- Opt. generator: 22kW or 2x11kW

# PLEASURE AND PLANET IN ELEGANT BALANCE

#SAILTHEPLANET





# THE SUPER VAAN

At 78 feet, the R8 elevates the Vaan concept to stunning superyacht proportions. Offering approximately 150m<sup>2</sup> of refined living space, five beautifully appointed rooms, an intelligent crew area, and an expansive forward cockpit. It is the embodiment of elegant sailing and modern luxury.



# R8

# MADE FOR SAILORS

Like all Vaan models, this catamaran is designed with sailors in mind. Featuring a signature low boom, aft helms, and an interior helm bridge, it perfectly balances the performance of a sailing yacht with the comfort of a luxury villa.

Its world-class naval architecture, combined with renowned Dutch craftsmanship, guarantees exceptional quality in every detail.



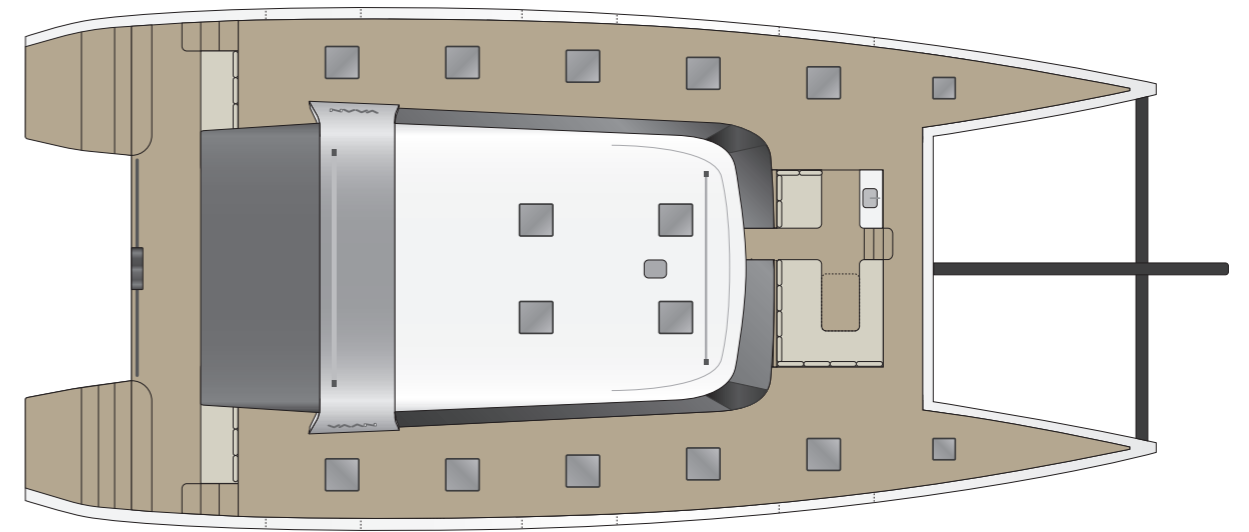

- Length: 78ft / 23.80m
- Beam: 11m

# DETAILS MATTER

Elegant design and attention to details; less is really more.



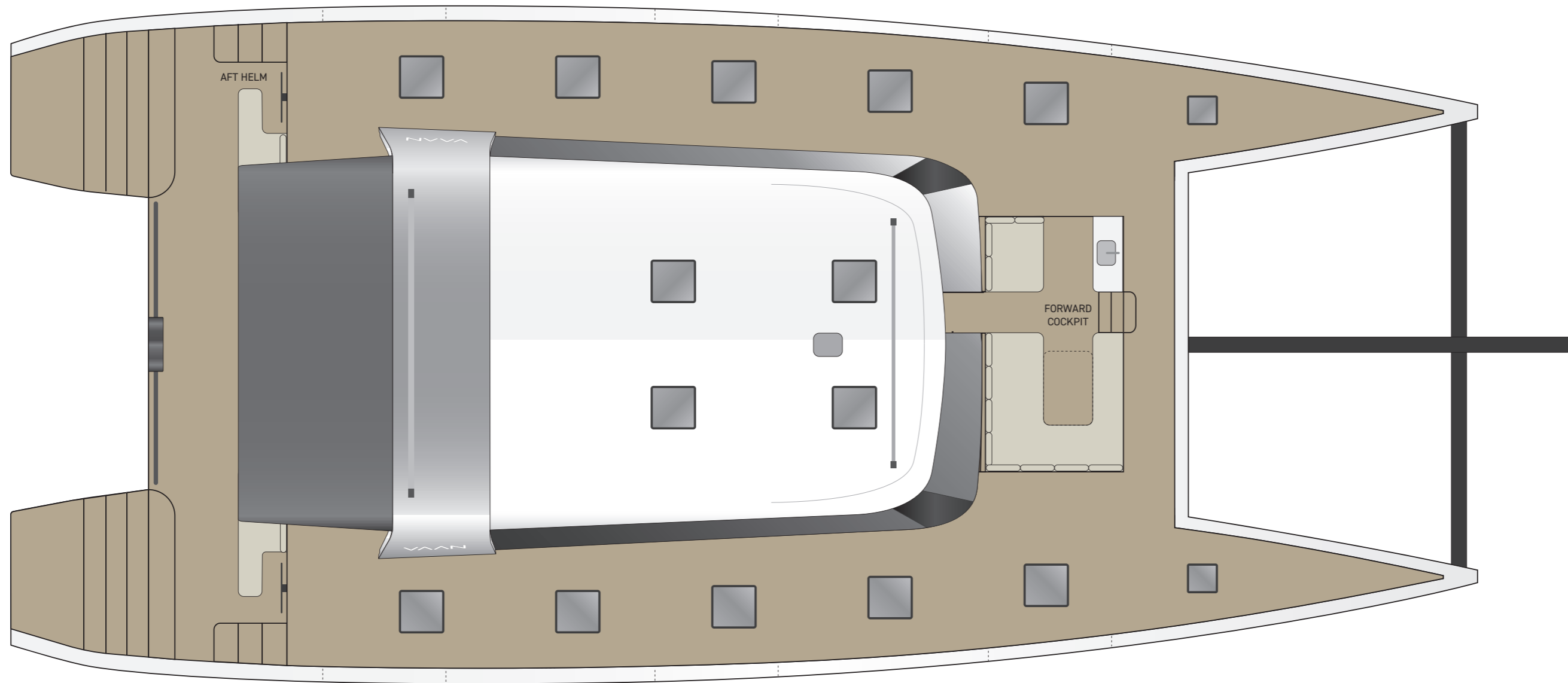

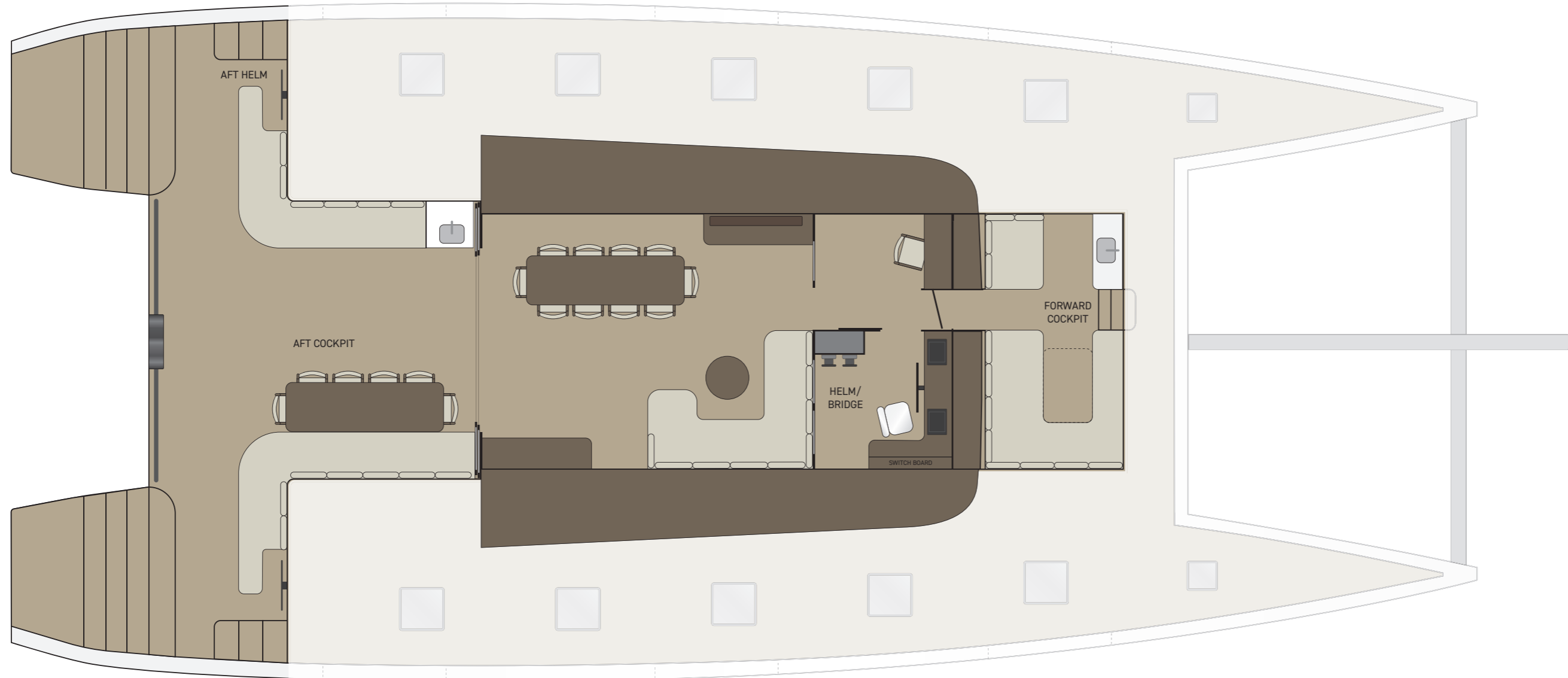





Each square = 1m<sup>2</sup>  
 Blue area = crew area

Galley and Bridge can be  
 used by crew or privately







# OPTIONS



# HULL COLORS



VIVID ALU  
STANDARD



SNOW WHITE  
OPTION

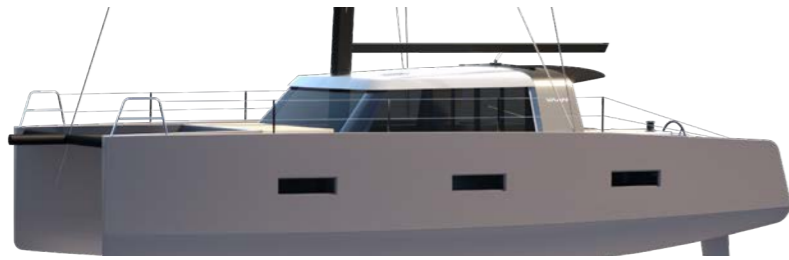

STONE GRAY  
OPTION



LAVA BLACK  
OPTION

# SPOILER

- 3 sizes: S/L/XL
- Lengths depend on model
- L and XL have support poles
- Spoiler S can be combined with Bimini

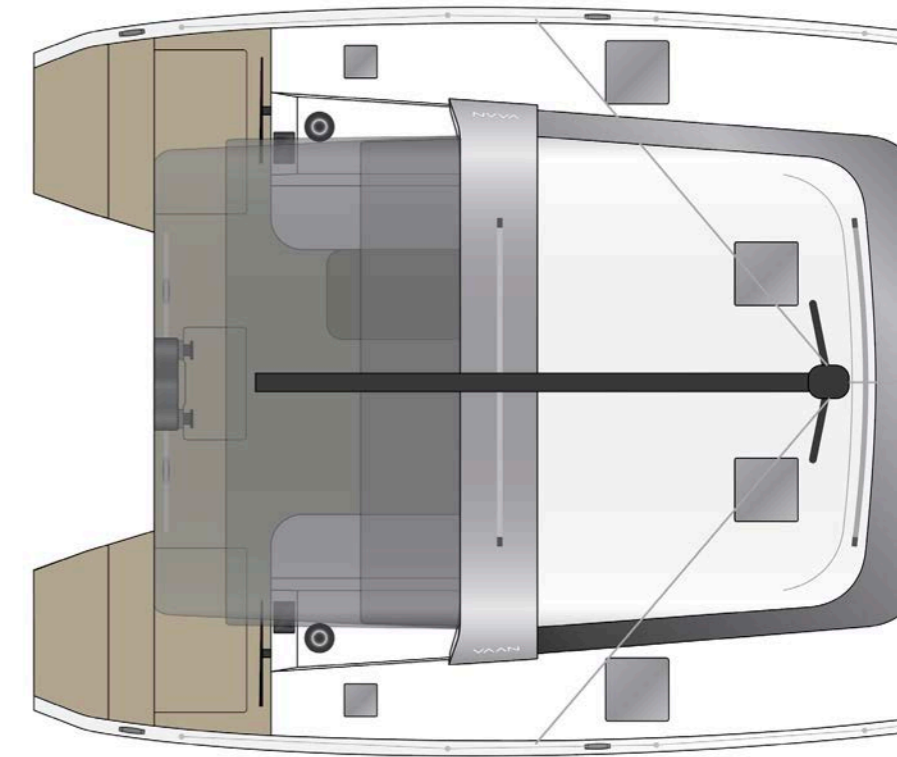
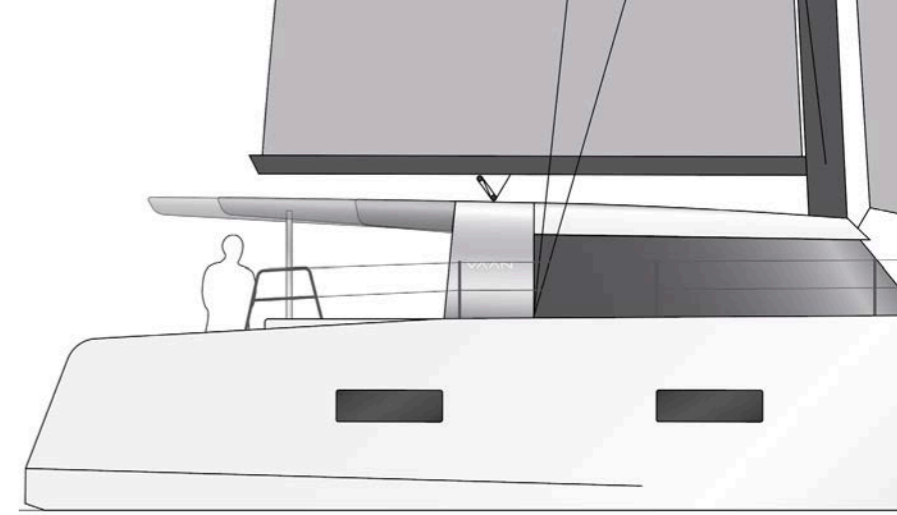

# FORWARD LOUNGE

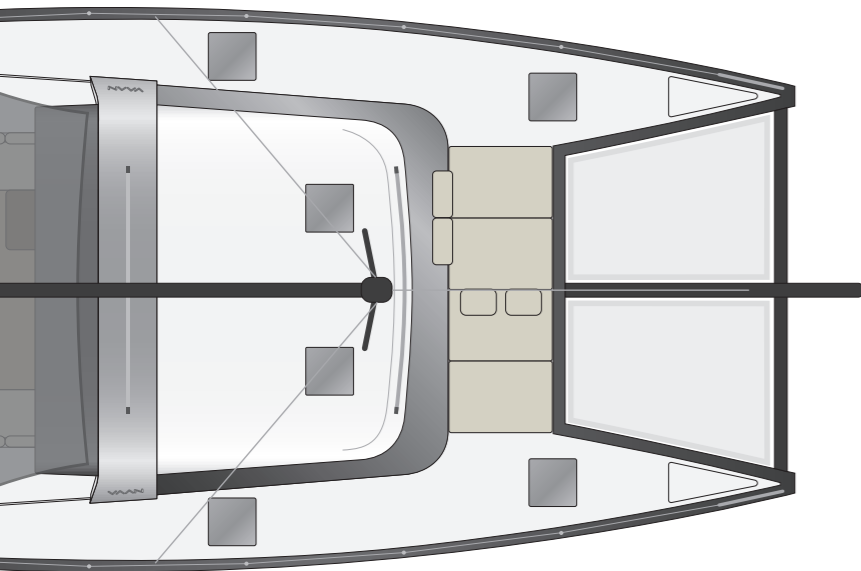
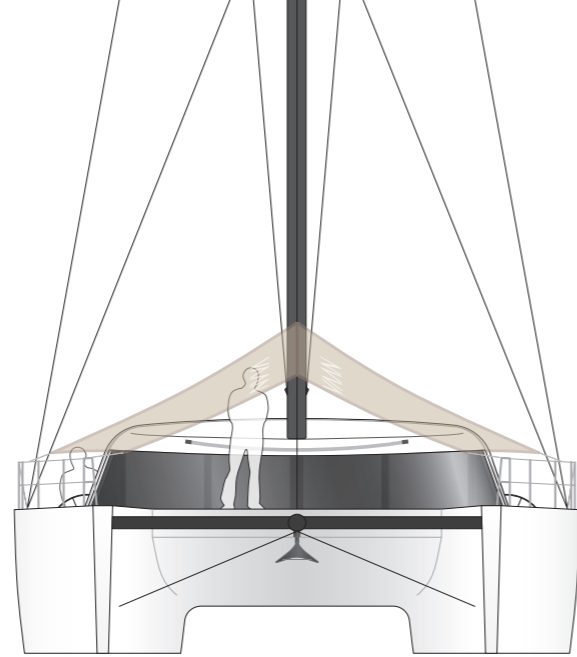

- Large lounge cushions
- (Partially) shaded when desired
- Installed in minutes
- Light-weight

# BIMINI

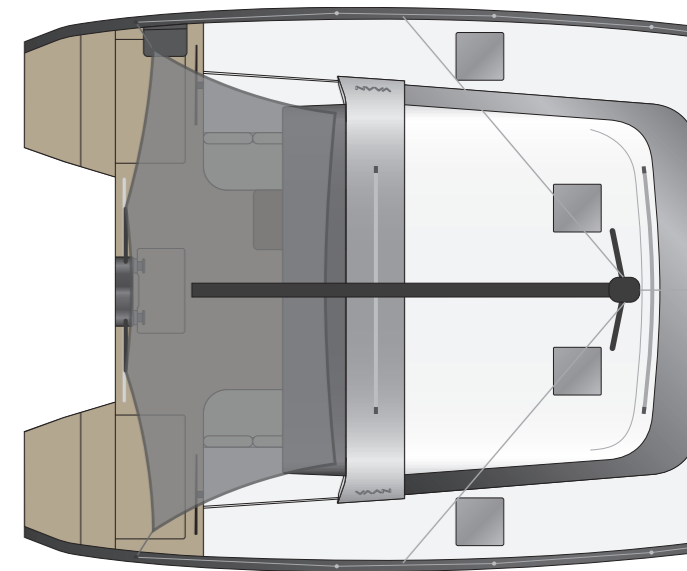
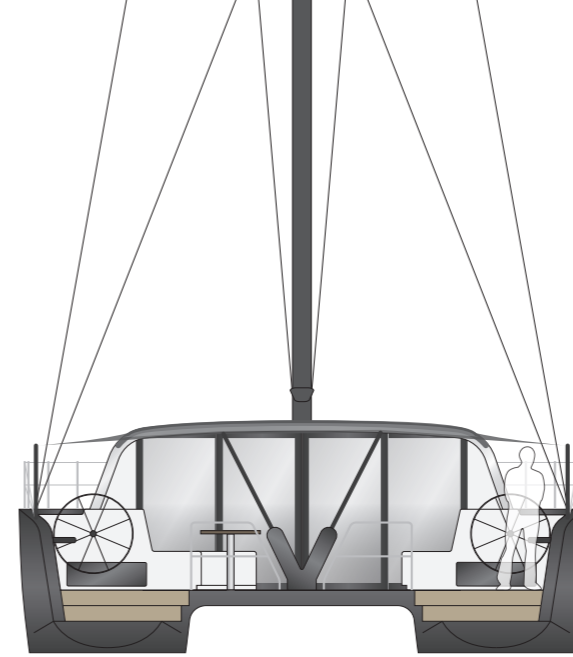

- Covers entire cockpit, including both helm positions
- Installed in minutes
- Light-weight

# FORWARD SEATING

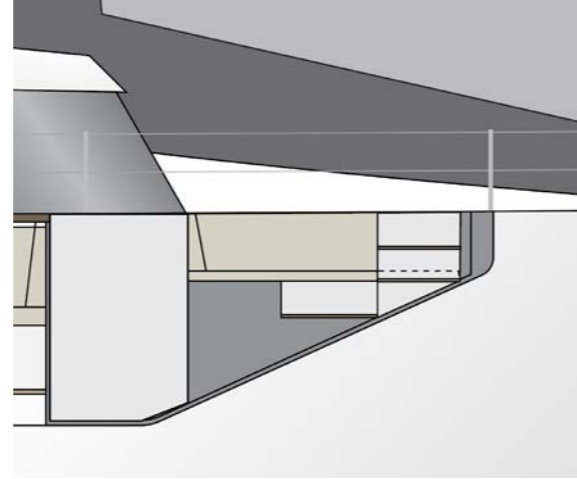
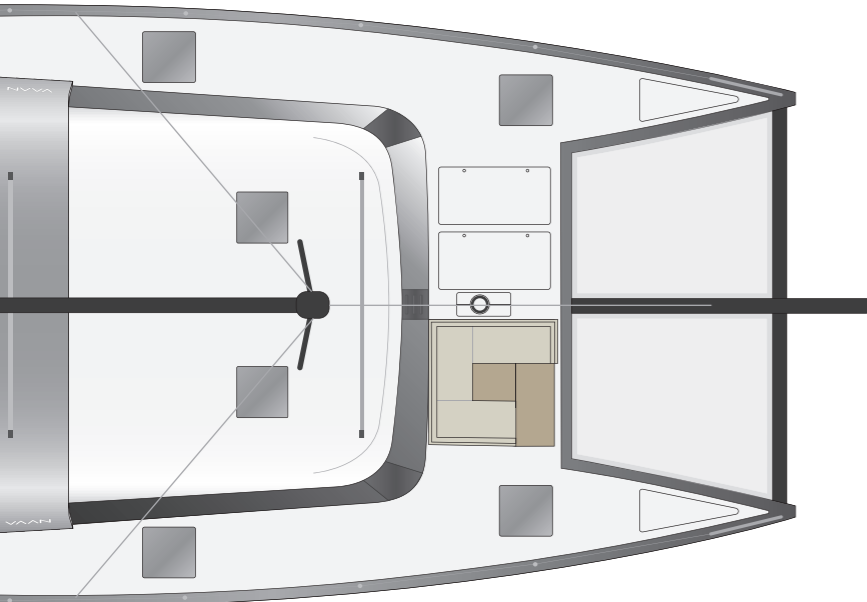

- R5 only
- Foldable table for drinks and bites

The plans, specifications, images and other details herein are only indicative and subject to change.

# DAVITS

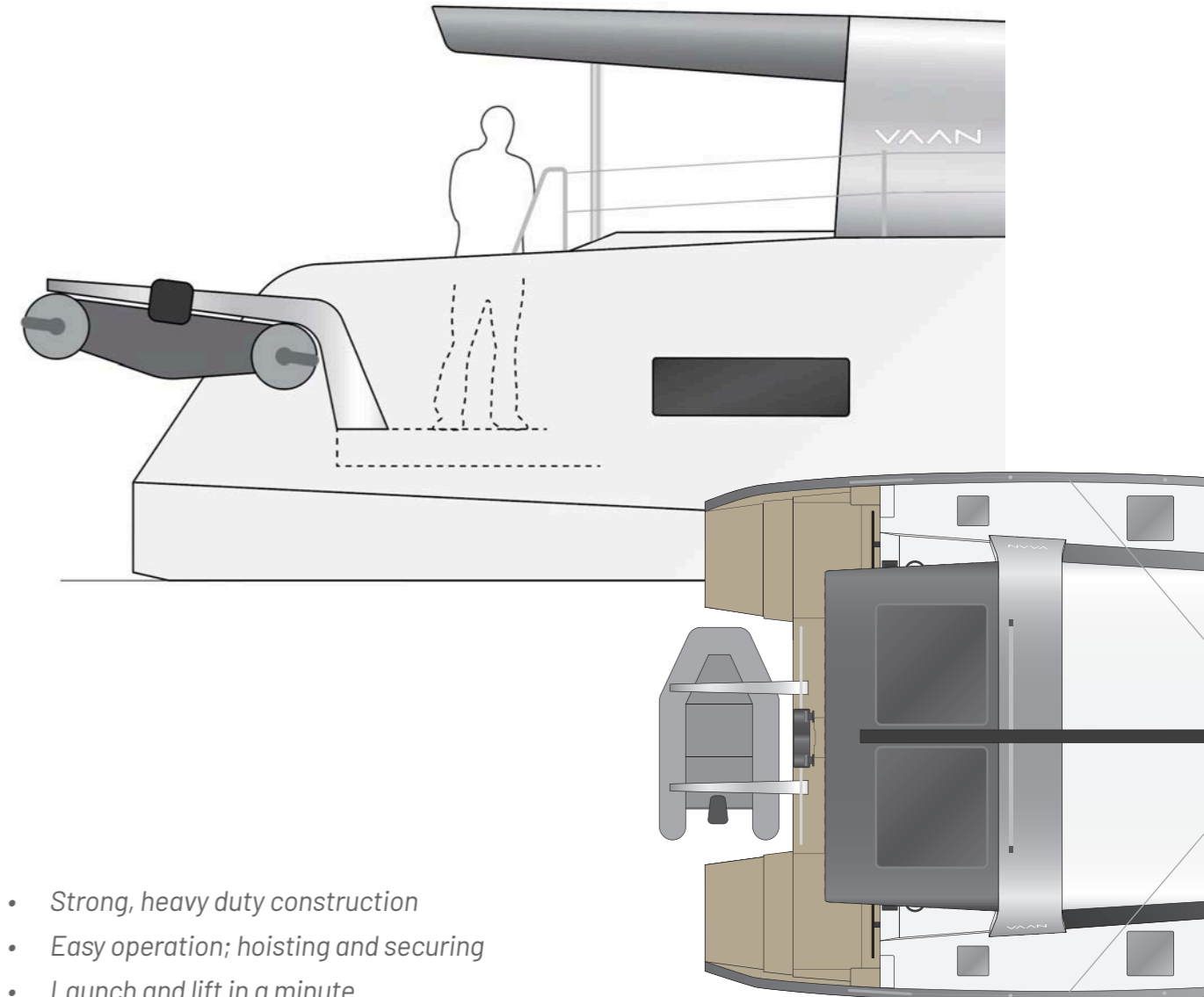

- Strong, heavy duty construction
- Easy operation; hoisting and securing
- Launch and lift in a minute

# EXTRA SOLAR

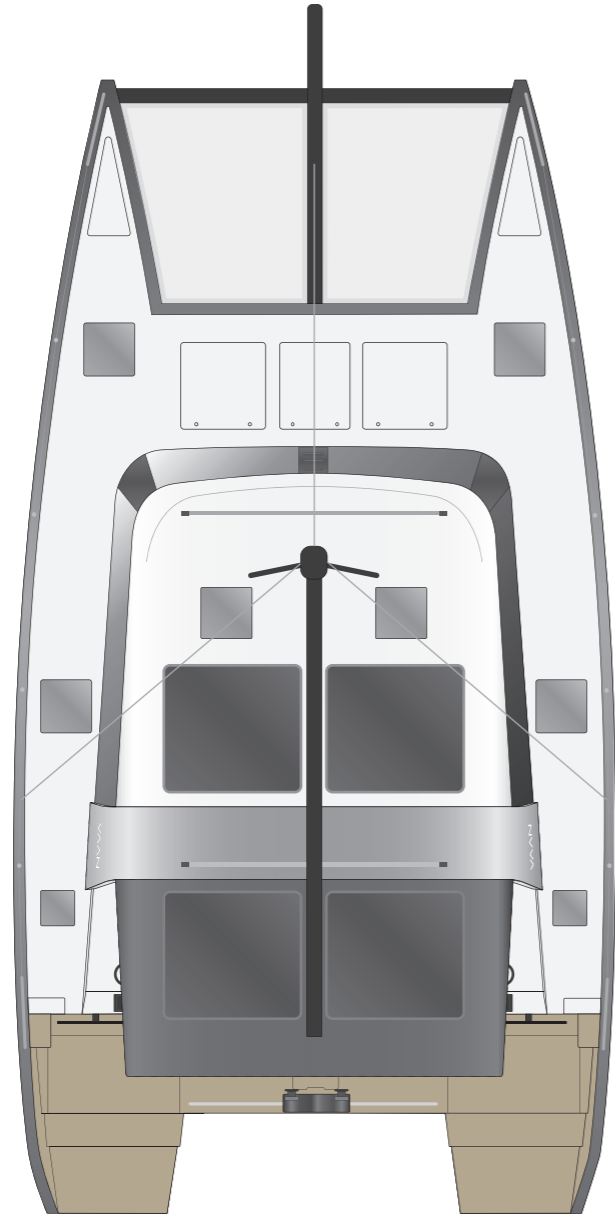

# SEATS & RAILINGS

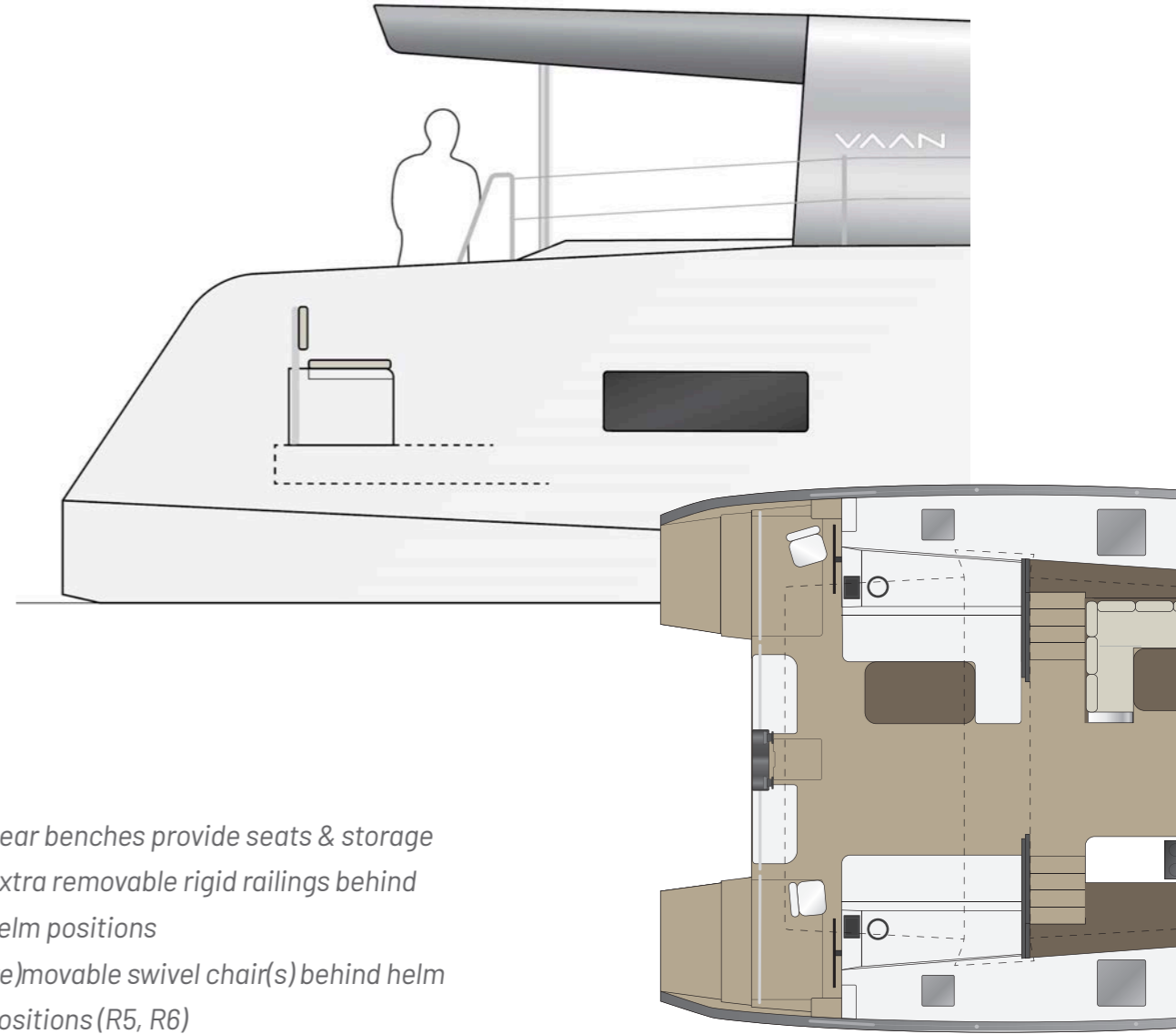

- Rear benches provide seats & storage
- Extra removable rigid railings behind helm positions
- (re)movable swivel chair(s) behind helm positions (R5, R6)



FOR THE HAPPY VIEW



[www.vaan.yachts](http://www.vaan.yachts) | [contact@vaan.yachts](mailto:contact@vaan.yachts) | +31 85 071 9999

Stationsplein 9 | 3224 AT | Hellevoetsluis | Holland

©2025 Vaan Yachts BV, Holland. All rights reserved.

All black & white photos by Maarten Corbijn ([corbino.nl](http://corbino.nl))

*Disclaimer: This brochure is meant only for promotional purpose and has no legal value. The plans, specifications, images and other details herein are only indicative and subject to change. Vaan reserves the right to change any or all of these designs and specifications without prior notice or obligation. Artists' impressions are used to illustrate the design only. This printed material does not constitute an offer, obligation and/or contract of any type.*

